

VACATION OF UTILITY EASEMENT

NAME: Central Parking Lot Corporation

PROPERTY ADDRESS: Parking lots bounded by 20th Street, Central Avenue, 15th Street & Deacon Street, Los Alamos, N.M. 87544

TRACT: EI, SUBDIVISION: Eastern Area No. 3

The Incorporated County of Los Alamos has determined that the County no longer requires and hereby vacates the utility easements described as follows:

DESCRIPTION

That utility easement lying and being within Tract EI, Eastern Area No. 3, Los Alamos County, New Mexico, the Plat thereof filed for record in the Office of the Clerk at Plat Book 1, Page 74 on February 21, 1966, as shown on that Plot Plan marked Exhibit "A", attached hereto and made a part hereof.

This Vacation of Utility Easement in no way effects, reduces or diminishes any other easement or usage, either drainage or utility, held by the Incorporated County of Los Alamos except as herein specifically provided. All other grants of easement, whether construction maintenance, drainage or utility, shall be and remain in full force and effect.

THIS VACATION OF UTILITY EASEMENT HAS BEEN REVIEWED BY ME AND IS ACCEPTABLE TO THE DEPARTMENT THAT I REPRESENT:

 11/12/19
COUNTY ENGINEER DATE

 11/12/19
COUNTY SURVEYOR DATE

 11/12/19
DEPARTMENT OF PUBLIC UTILITIES DATE

ATTEST:
Naomi Maestas

INCORPORATED COUNTY OF LOS ALAMOS

By: _____
County Clerk
Recorded pursuant
to NMSA 1978,
14-9-7.

COUNCIL CHAIRPERSON DATE

PLOT PLAN FOR
VACATION OF UTILITY EASEMENT
within
TRACT EI,
EASTERN AREA NO. 3
LOS ALAMOS, NEW MEXICO
for
CENTRAL PARKING LOT CORPORATION

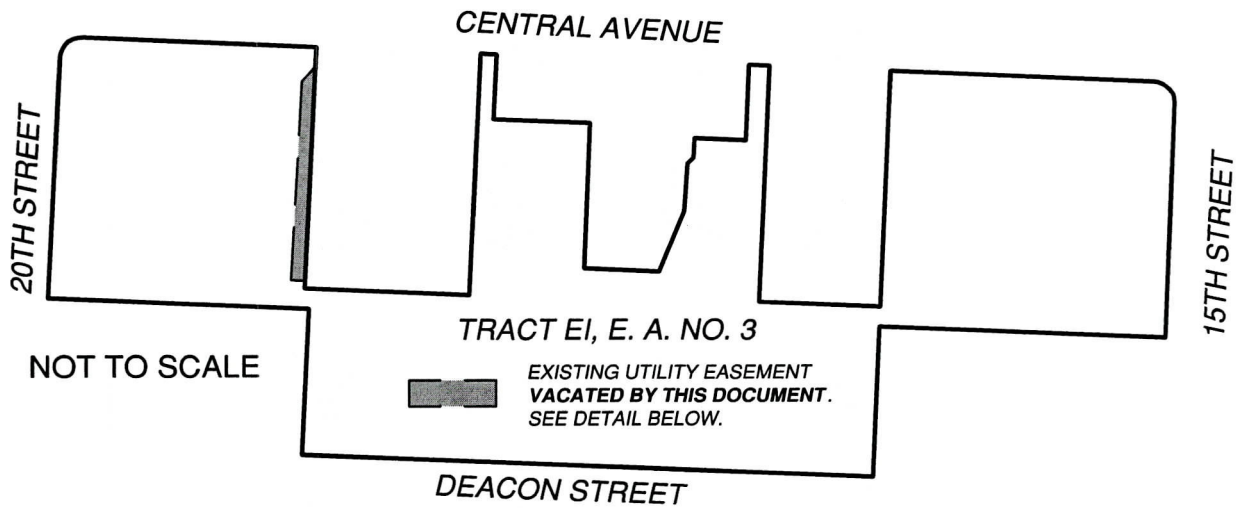

S 87°27'48" E

163.34'

176.54'

TRACT EI, EASTERN AREA NO.3

EXISTING UTILITY EASEMENT
VACATED BY THIS DOCUMENT.
ALL OTHER EASEMENTS-UTILITY,
DRAINAGE AND CONSTRUCTION
MAINTENANCE EASEMENTS
REMAIN IN EFFECT FOR THIS
TRACT.

TRACT ED, EASTERN AREA NO.3

SCALE 1" = 40'

10' UTILITY EASEMENT

10' UTILITY EASEMENT

N 88°29'43" W

N 02°40'12" E

5.67'

67.00'

S 87°28'21" E

79.88'

182.06'

TRACT EA

TRACT EB

TRACT EC

TRACT EI, EASTERN AREA NO.3

AUTHORITY:

THIS PLOT PLAN WAS PREPARED FROM INFORMATION SHOWN ON THE PLAT EASTERN AREA NO. 3, SAID PLAT BEING FILED FOR RECORD IN THE OFFICE OF THE COUNTY CLERK OF LOS ALAMOS COUNTY, NEW MEXICO IN PLAT BOOK 1, PAGE 74 ON THE 21ST DAY OF FEBRUARY, 1966 AND FROM INSTRUCTION PROVIDED BY THE LOS ALAMOS COUNTY UTILITY DEPARTMENT.

LARRY W. MEDRANO, N.M.P.L.S. NO. 11993

DATE 11-15-2019

1362 Trinity Drive, Suite A2
Los Alamos, NM 87544
505.661.4262 PHONE
505.661.4263 FAX

M.B.E.
10/29/2019

