



LOS ALAMOS COUNTY

# North Mesa Recreation Area Master Plan

---

January 27, 2026



# **Tonight's Presentation**

- Project Introduction
- Community Engagement
- Final Concept Design
- Revised Final Concept Design
- Costs and Phasing
- Questions

# Project Area





# Community Engagement



## Listening Sessions

- March
- In-person & online
- 125 attendees



## Community Workshop

- April
- In-person & online facilitation
- 50 attendees



## Open House & Survey

- July
- In-person & online facilitation
- 70 attendees
- 190 responses



# Final Concept Design



# Community-shaped Final Conceptual Master Plan



**3-5-acre  
Bike Park**



**Sand  
Volleyball  
Courts**



**Children's  
Nature Play  
Area**



**NORTH MESA RECREATIONAL AREA**

**FINAL PREFERRED OPTION**

**CONCEPTUAL MASTER PLAN**

Los Alamos, New Mexico  
Conceptual Design  
December 16, 2025

ATTACHMENT A

**LOS ALAMOS**  
where discoveries are made

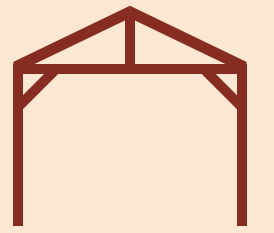

**Multi-Use  
Pavilion**

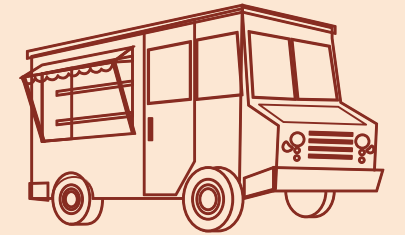

**Food Truck  
Court**



**Expanded overflow  
parking with six ADA  
parking spots and direct  
driveway to rodeo  
grounds**



**Make existing  
community garden ADA  
compliant, allow space  
for future expansion**



# Phasing & Cost Estimates

# Phasing Priorities

1



**Bike Park  
(Pump  
Track/Skills  
Area)**

2



**West Side  
Paths &  
Parking**

3



**Sand  
Volleyball &  
Dog Park  
Improvements**

4

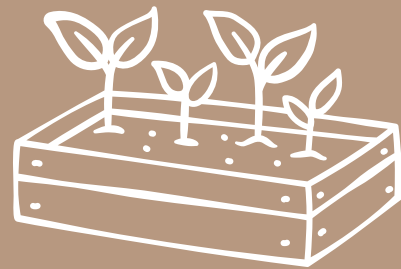

**Community  
Gardens**

5



**Multi-Use  
Pavilion &  
Food Truck  
Plaza**

**Flexible/  
Ongoing**

**Playgrounds &  
Related  
Amenities**



# Phasing Map

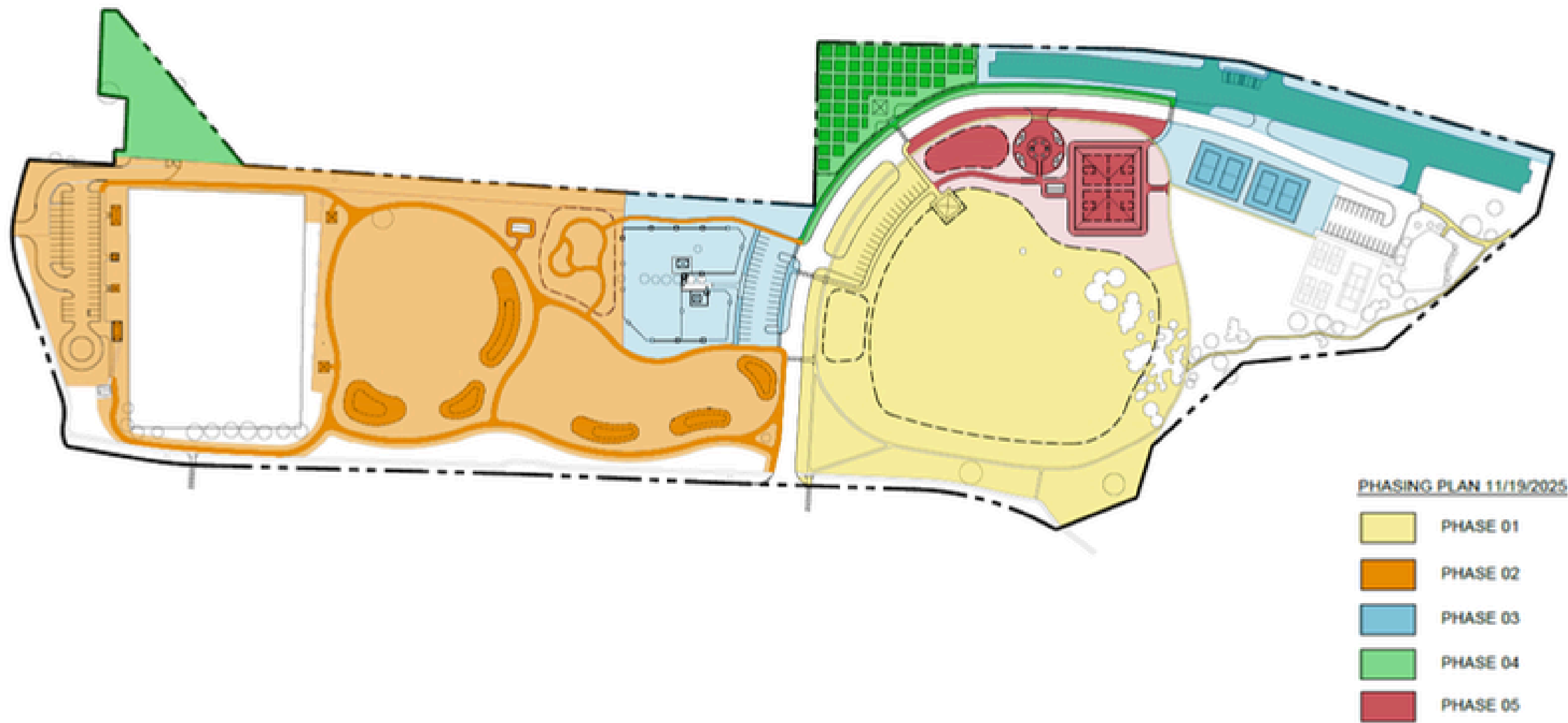

# Cost Estimates (Approximate)

## Phase 1

Bike Park

**Total:**

**\$3,500,000**

## Phase 2

West Side Paths &  
Parking,  
Landscaping

**Total:**

**\$2,100,000**

## Phase 3

Sand Volleyball  
& Dog Park  
Improvements

**Total:**

**\$1,300,000**

## Phase 4

Community  
Gardens

**Total:**

**\$800,000**

## Phase 5

Multi-Use Pavilion  
& Food Truck  
Plaza

**Total:**

**\$4,000,000**

## Flexible/ Ongoing

Playgrounds &  
Related Amenities

**Total:**

**\$1,300,000**

**Grand Total for Entire Project: \$12,900,000**



# Questions?