

Arts in Public Places Collection

Flower of Flight

by Greg Reiche

These limestone monoliths invite reflection on art and nature. Carved to capture rainwater, they nurture moss and lichens, transforming into a living artwork. This dynamic piece celebrates life’s resilience, merging human craftsmanship with the organic world. Contrasting the solid nature of the monoliths, the colored, kinetic glass tiles allude to flowers and the processes of pollination.

Like the ancient rocks in nearby forests, the sculpture evolves with the seasons, shaped by time and elements. Visitors are encouraged to pause and observe its growth, highlighting the interconnectedness of all living things. Ultimately, it embodies the idea that art is not just to observe but to experience as a living phenomenon.



Above: Flower of Flight when installed in 2015; Right: Flower of Flight in the rain after the first few years of growth in 2018. (photos by Leslie E. Bucklin)

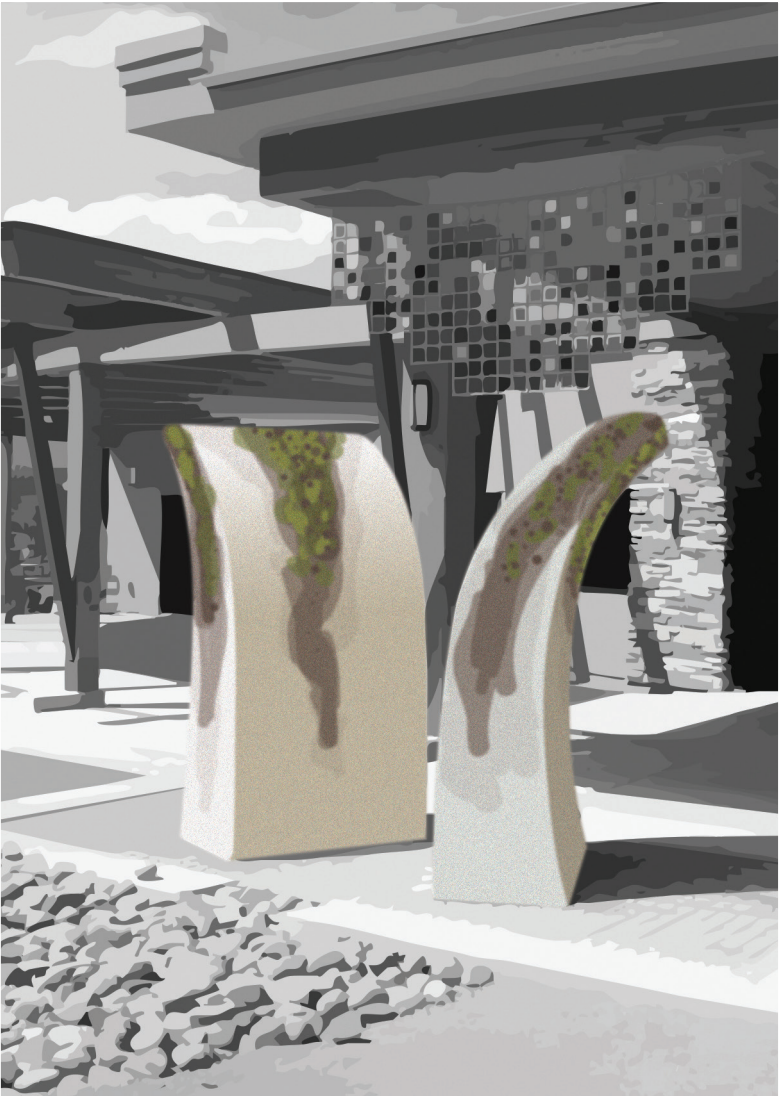

Conceptual Illustrations of Flower of Flight with growth over time: 15 years
(illustrations by Sara Canfield and Rachel Freeman)



25 years



35 years



Visit the Los Alamos County
Arts in Public Places collection
online at WWW.LACNM.COM/ART