

North Mesa Shared-Use Gymnasium

Incorporated County of Los Alamos
Public Works Department &
Community Services Department

January 12, 2023

fbt | architects



Los Alamos
PUBLIC SCHOOLS

LOS ALAMOS

Pre-Design Phase

Complete

Site Evaluation & Programming (Facility Size) Options (small / medium / large)

- June 1, 2022: Public Meeting
- June 7, 2022: County/LAPS Stakeholder Group Evaluation
- June 8-24, 2022: Public Survey Open; 410 Responses Received
- June 9, 2022: Parks & Recreation Board (PRB) Presentations
- August 11, 2022: PRB Recommends Site C (south) & Large Program
- **August 29, 2022: Joint Session to Consider:**
 - Site & Programming Options
 - i.e., Project Scope and Budget

Site C (south) &
Large Program
selected



Los Alamos
PUBLIC SCHOOLS



architects LOS ALAMOS

Site Option C Selected

Basis of Selection for Site C:

- Flexibility to expand
- Athletic zone
- Better
 - Construction logistics
 - Educational functionality
 - Community amenities

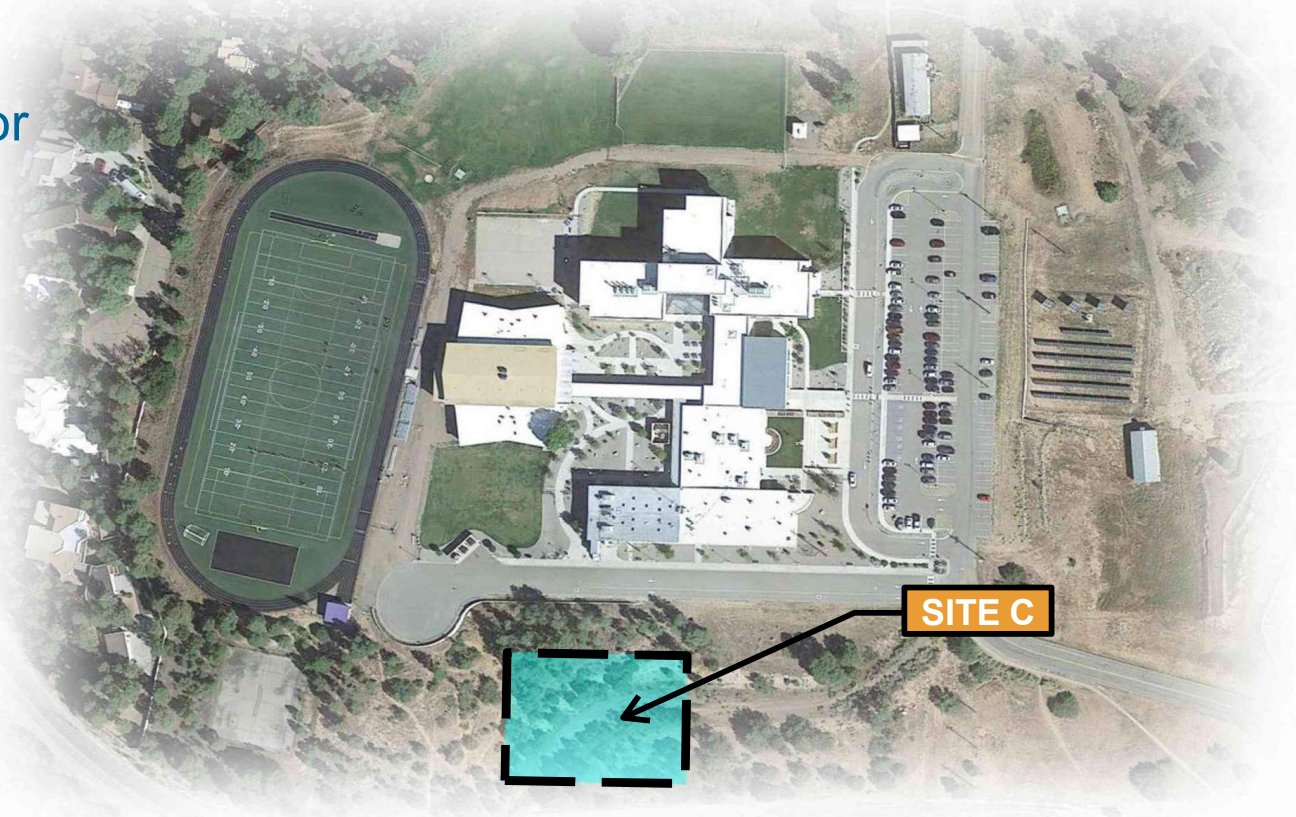



LOS ALAMOS MIDDLE SCHOOL - SITE C

Schematic & Design Development

Design Committee & Design Team

- Geotechnical Investigation, Utility Planning, Site Survey
- 30% & 60% Design & Cost Estimates
- Design Team Review
- Public Presentations
 - January 12 – Parks and Recreation Board
 - January 26 – School Board
- **February 2023 (tentative): Council to Consider:**
 - Budget options for full or phased project



Los Alamos
PUBLIC SCHOOLS

fbt | architects LOS ALAMOS

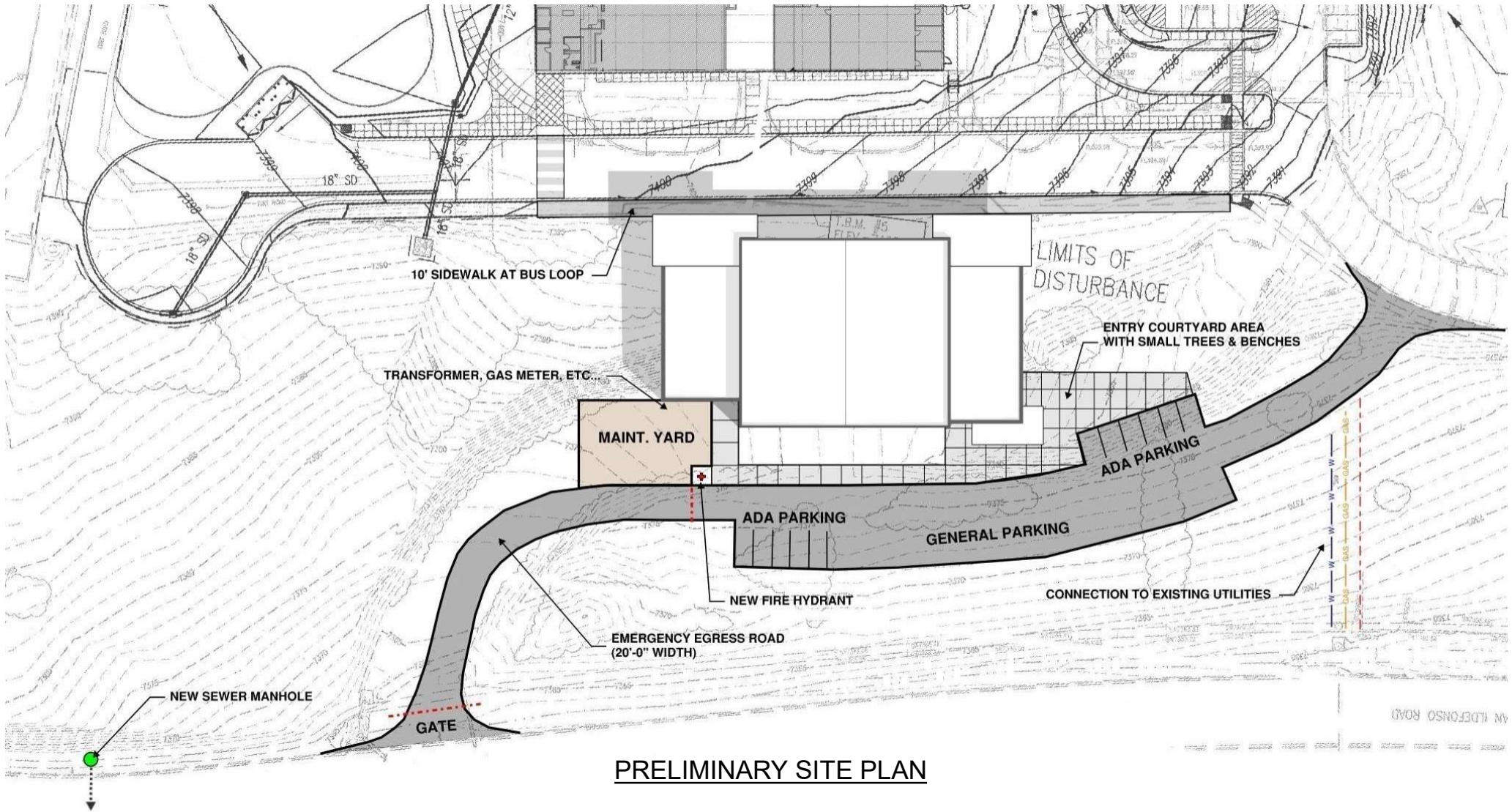

PRELIMINARY SITE PLAN

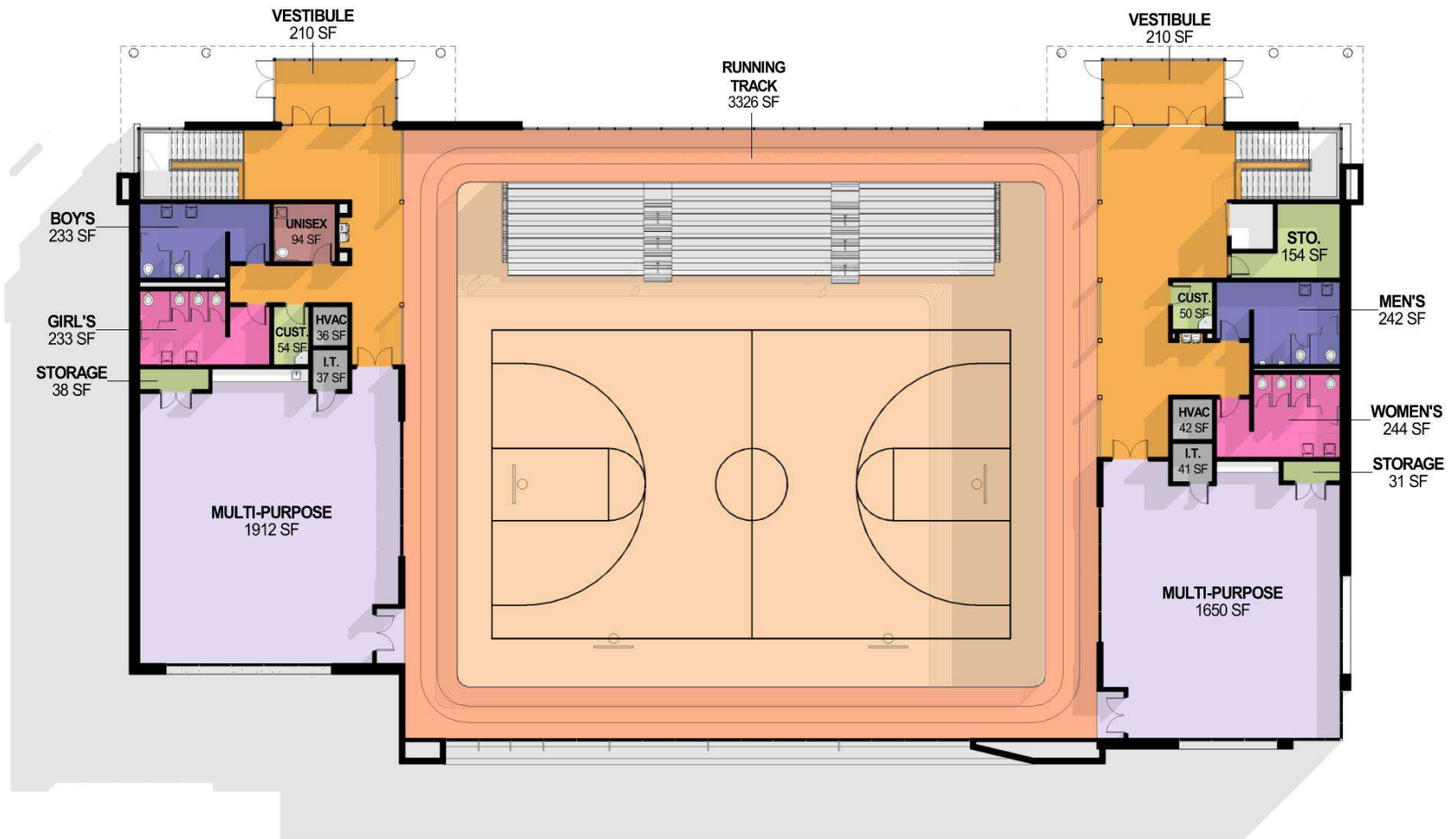

UPPER LEVEL FLOOR PLAN 11,939 GSF
(29,806 TOTAL)

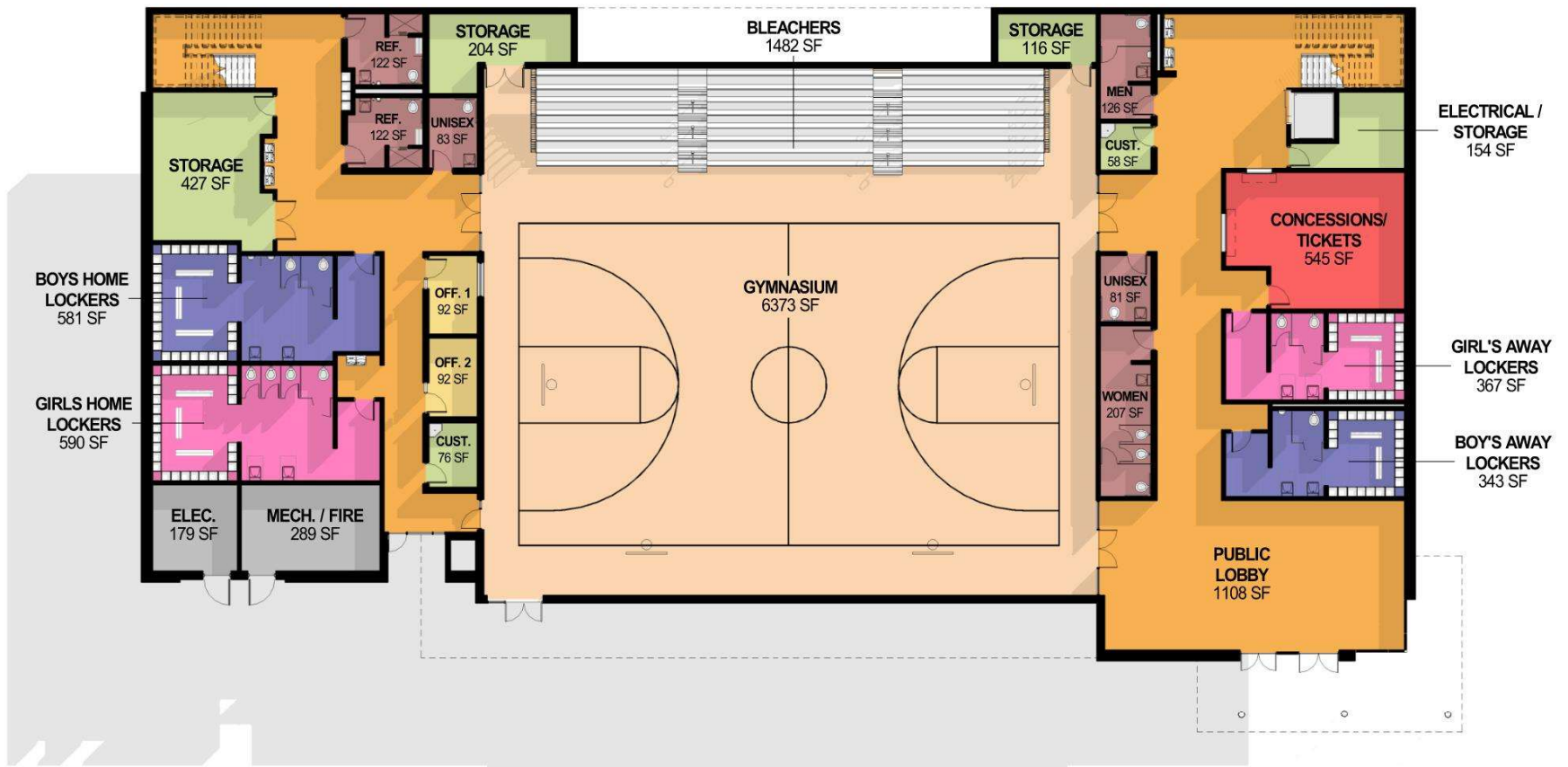

LOWER LEVEL FLOOR PLAN 17,867 GSF
(29,806 TOTAL)

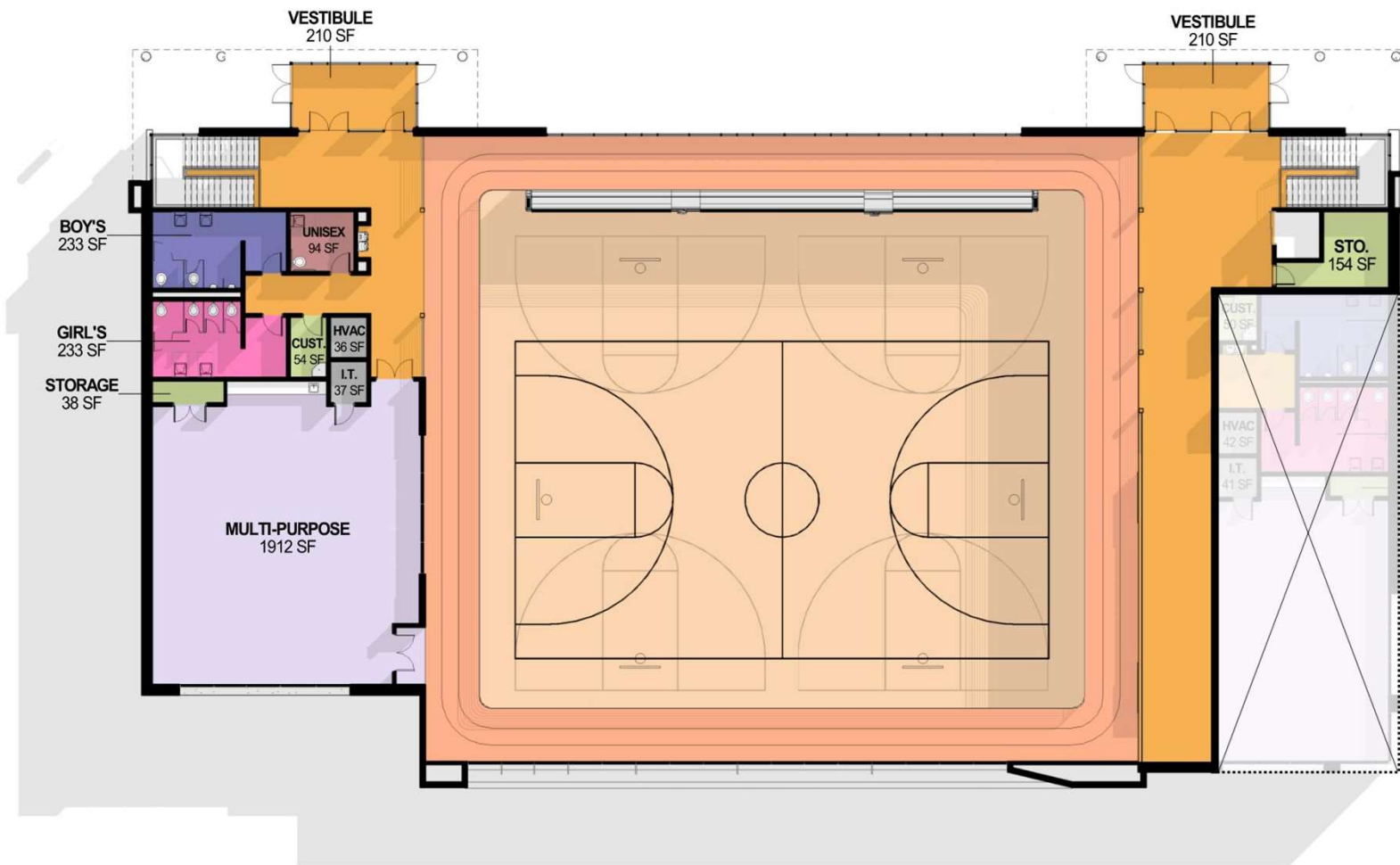

UPPER LEVEL PHASING 9,668 GSF
(25,414 TOTAL)

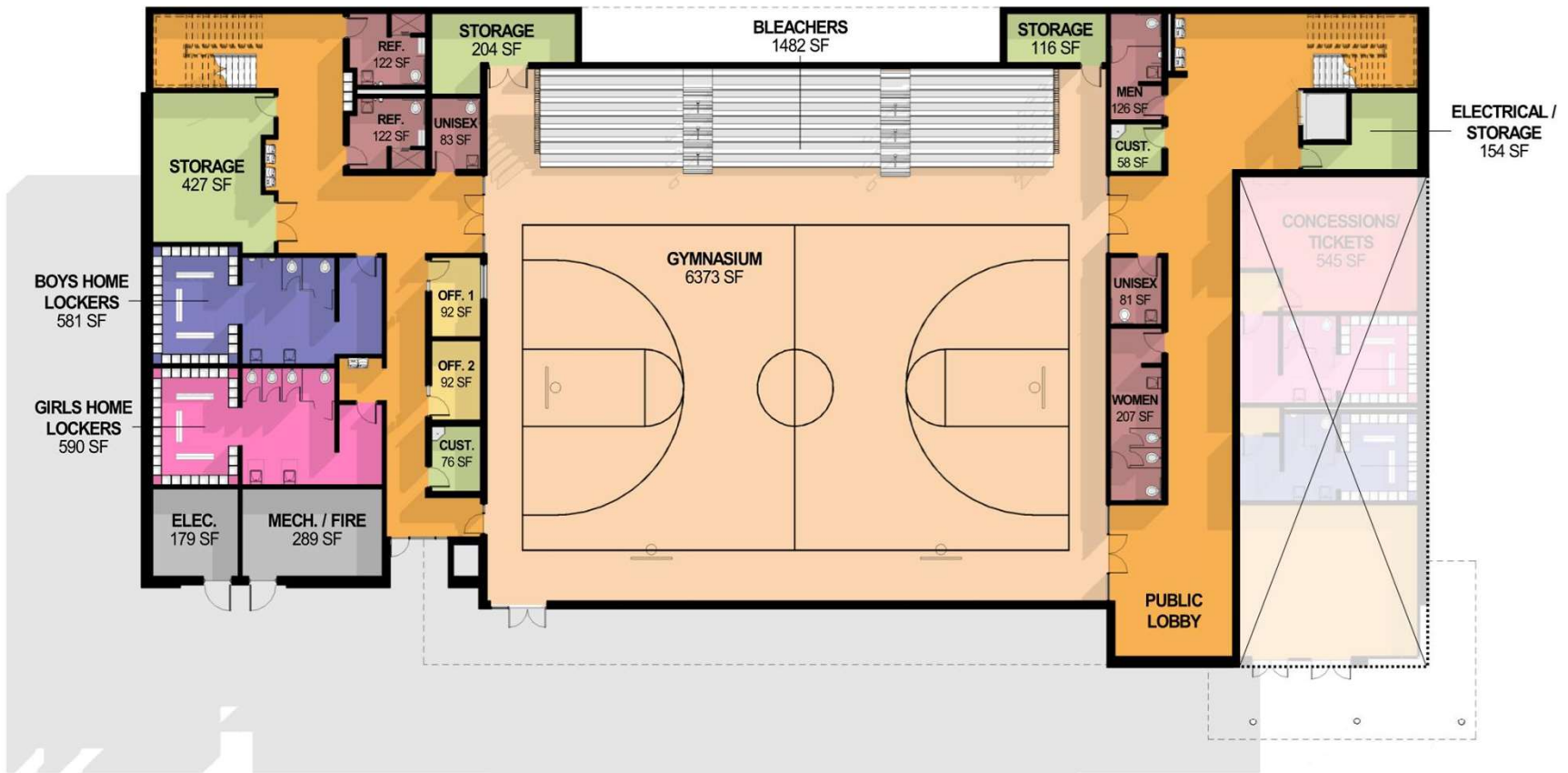

LOWER LEVEL PHASING 15,746 GSF
(25,414 TOTAL)



INTERIOR RENDERING - GYMNASIUM



INTERIOR RENDERING – RUNNING TRACK



INTERIOR RENDERING – MULTI-PURPOSE ROOM



FULL PHASE
EXTERIOR RENDERING – LOWER LEVEL ENTRY



FULL PHASE
EXTERIOR RENDERING – SOUTH FACADE



FULL PHASE
EXTERIOR RENDERING – UPPER LEVEL ENTRY



Los Alamos
PUBLIC SCHOOLS

fbt

architects

LOS

ALAMOS



PHASE 1
EXTERIOR RENDERING – LOWER LEVEL ENTRY

 **Los Alamos**
PUBLIC SCHOOLS **fbt** | architects **LOS ALAMOS** 

Future Considerations

Agreements

- Memorandum of Understanding
- Joint Use Agreement

Construction Costs by County

- School capital funding constraints
- LAPS In-kind contributions
- County CIP funds and State Grant

Operational Costs by LAPS

- Labor, Utilities, Maintenance



Los Alamos
PUBLIC SCHOOLS

fbt

architects LOS ALAMOS

Current & Next Steps

- Schematic Design
 - Geotechnical Investigation & Site Survey
 - 30% Design & Cost Estimates
 - Design Team Review
- Design Development
 - 60% Design & Cost Estimates
 - Design Team Reviews
 - Public Meetings:
 - Parks & Recreation Board (Jan. 12) and School Board (Jan. 26)
 - Council (TDB)
- Secure Funding for Step 2 (TBD)
 - Construction Plans & Bid Documents
 - Bidding, Award & Construction

Step 1
In Process

Step 2
Pending



Los Alamos
PUBLIC SCHOOLS

fbt

architects LOS ALAMOS

Discussion & Questions



Los Alamos
PUBLIC SCHOOLS

fbt

architects

LOS

ALAMOS