



LOS ALAMOS COUNTY

North Mesa Recreation Area Master Plan

October 9, 2025



Agenda

- Introduction
- Timeline
- Community Engagement
- Final Concept Design
- Phasing
- Questions



Meet Our Team



Dani Wilson
Senior Planner/PM



Bob Oberdorfer
Landscape Architect



Karina Rodgers
Planner/PM



Norma Oder
Landscape Architect



Allison Long
Senior Planner

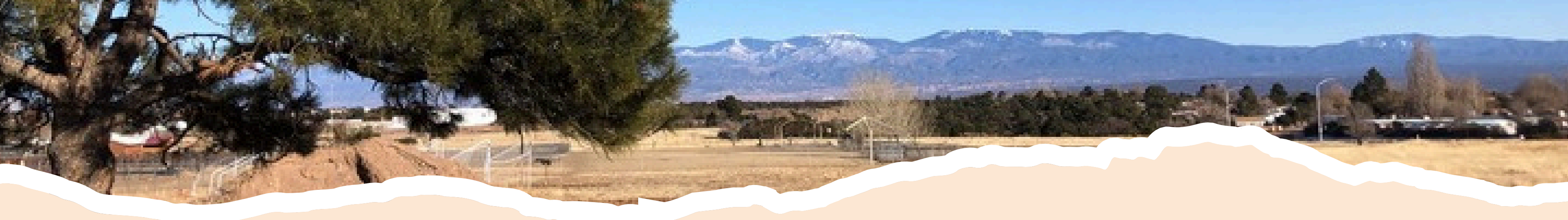

Plan Purpose

The purpose of the plan and the planning process was to document the community's vision for the space, analyze existing conditions (including site constraints and opportunities), and provide a conceptual framework for future preservation and/or improvements.

We want to accommodate the recreation needs of all users.

Project Area





Project Timeline



December 2024 - March 2025

- Project kick-off
- Site evaluation
- Listening sessions



April - August

- Community workshop
- Open House
- Analyze engagement
- Plan development
- Staff review



September - December

- Public review
- Present to Parks and Rec Board
- Final design
- Staff review
- Present to City Council



What We Heard

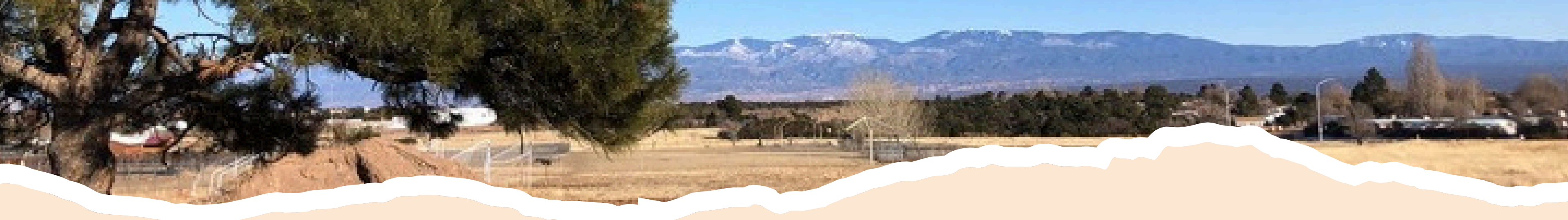

Emerging Vision

North Mesa is an environmentally-conscious, multi-recreational space that blends community values, active lifestyles, and nature — while being safe, inclusive, and flexible enough to serve a broad range of user groups.

Preserve What Works



Existing trees and open space to maintain the natural feel and dark skies.



Kwage Mesa Trailhead access and dirt walking paths, which provide valued trail connectivity.

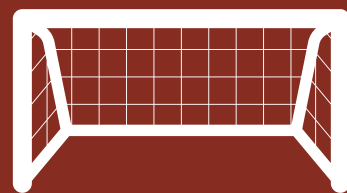

The soccer fields, dog park, tennis courts, and community garden, with interest in possible garden expansion.



The stables, which many see as an integral part of North Mesa's character and history.



Desired Improvements

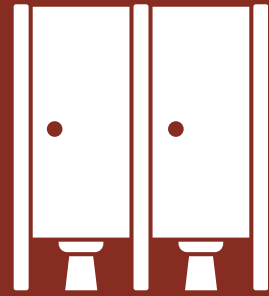

Restrooms:
more facilities, better
maintenance, and
ADA-accessible
options.

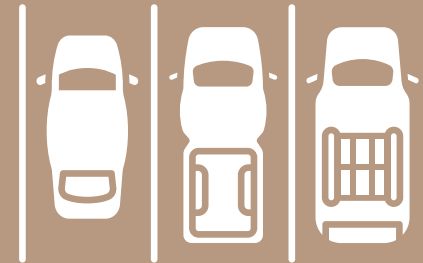

Parking & circulation:
improved layout to
manage increased use
while protecting
sensitive areas near
the stables.



Shade & landscaping:
permanent structures
and tree plantings to
provide relief from sun
and wind.



Signage & safety:
clearer wayfinding,
trail etiquette
education, and buffers
between horses and
bikes.



Dog park:
drainage fixes,
separate areas for
large/small dogs,
more shade, and
seating.



Playground:
fenced for safety,
refreshed equipment,
and shade structures.

New Amenities Requested



Bike infrastructure: pump track, progressive skills park, & connect to nearby trails. These features were the most consistently requested across all meetings.



Indoor sports space: regulation-sized multi-use facility, potentially indoor or covered, that could host roller derby, basketball, & other sports.

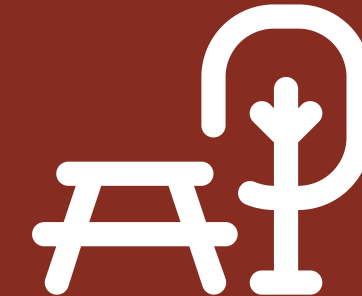

Picnic & gathering spaces: shaded seating areas, a central pavilion, and potential bandstand or flexible event area.



Water features: splash pad, drinking fountains, water bottle fillers, and dog stations.



Fitness & nature elements: outdoor exercise stations, pollinator gardens, and nature play areas integrated into the site.

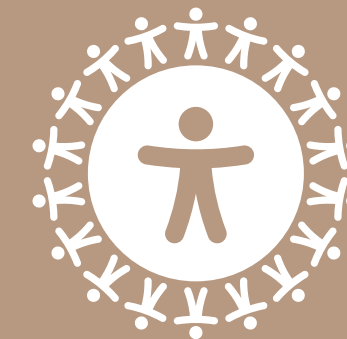

Accessibility: trails and play areas designed for all abilities, including adaptive sports.

How We Heard



Listening Sessions

- March
- In-person & online
- 125 attendees



Community Workshop

- April
- In-person & online facilitation
- 50 attendees



Open House & Survey

- July
- In-person & online facilitation
- 70 attendees
- 190 responses



Final Concept Design



NORTH MESA RECREATIONAL AREA

FINAL PREFERRED OPTION

CONCEPTUAL MASTER PLAN

Los Alamos, New Mexico
 Conceptual Design
 September 18, 2025

LOS ALAMOS
 where discoveries are made



Key Features



**3-acre bike
park &
pump track**



**Updated
community
garden
w/room for
expansion**

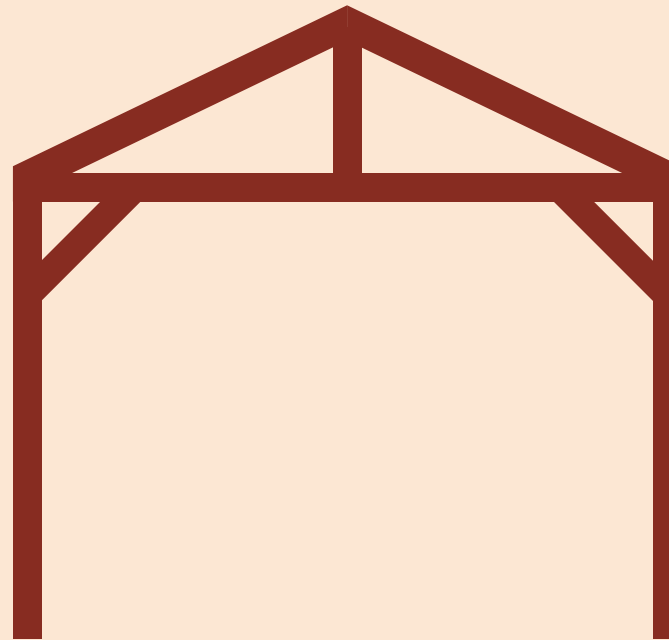

**Multi-use
pavilion**



**Sand
volleyball
courts**



**Children's
natural play
area**

Phasing

1



**Bike Park
(Pump
Track/Skills
Area)**

2



**Community
Garden**

3



**Sand
Volleyball &
Dog Park
Improvements**

4

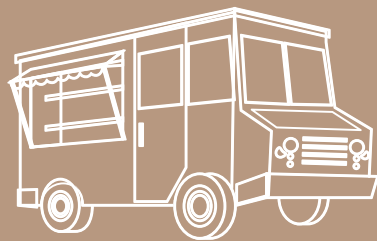

**Multi-Use
Pavilion &
Food Truck
Plaza**

5

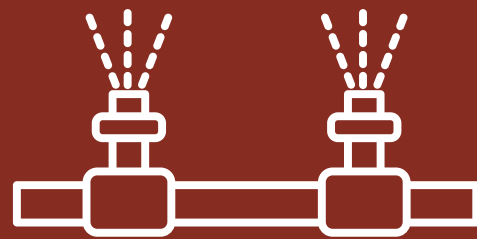

**Westside
General
Improvements**

**Flexible/
Ongoing**

**Playground
(as budget
allows)**



Questions?



Thank you!

Project Website

[https://www.losalamosnm.us/
County-Projects/North-Mesa-
Recreation-Master-Plan](https://www.losalamosnm.us/County-Projects/North-Mesa-Recreation-Master-Plan)

