

**AMERICAN  
RAMP  
COMPANY**

## **WHITE ROCK SKATEPARK SURVEY**

**WHITE ROCK, NM**

**72 PARTICIPANTS**

# TOP 3 ZIP CODES

38



8  
7  
5  
4  
7

27



8  
7  
5  
4  
4

1



8  
5  
7  
4  
7

# PARTICIPANT AGES

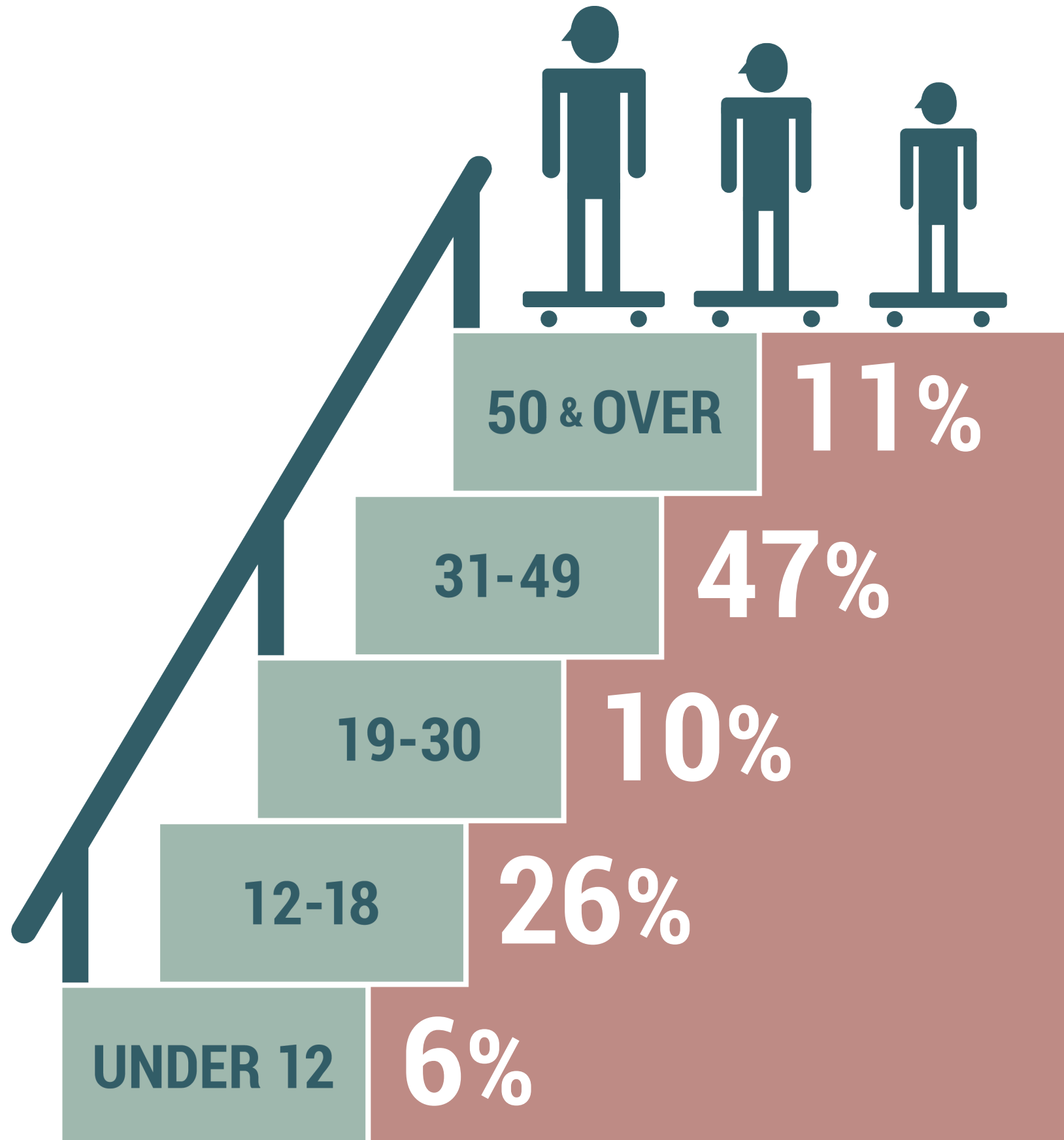

# TRANSPORTATION

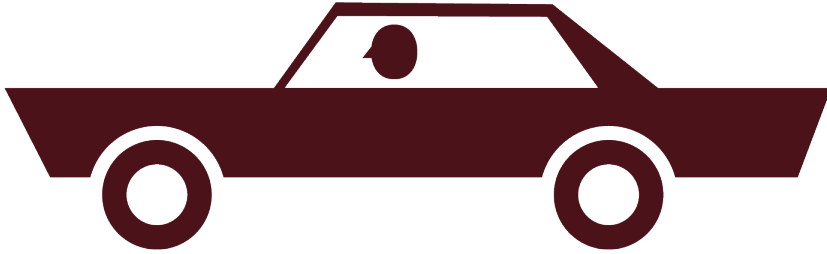

**61%**  
**DRIVE**

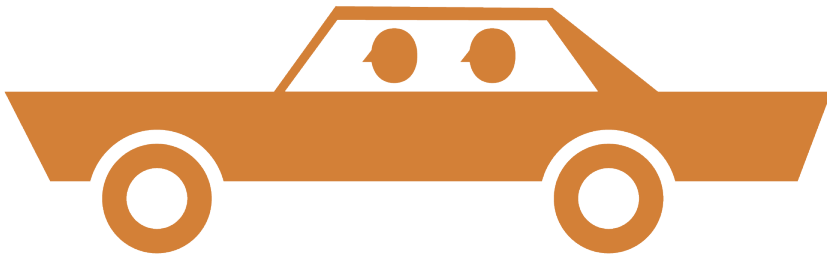

**8%**  
**CARPOOL**

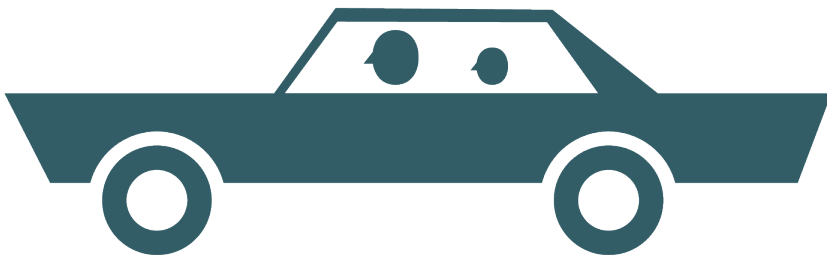

**6%**  
**GUARDIAN**

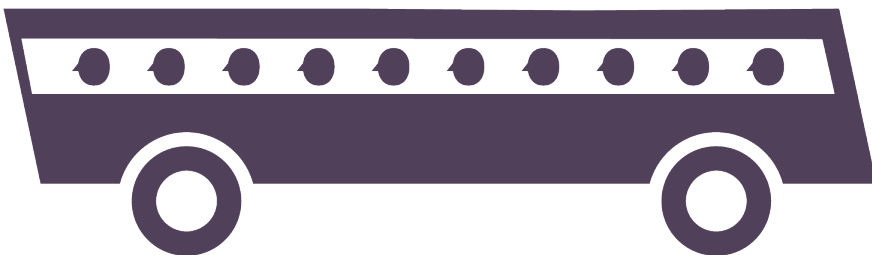

**3%**  
**PUBLIC**



**22%**  
**SKATE / RIDE**

# PARK CALENDAR USE

DAILY

12%

WEEKLY

36%

MONTHLY

35%

YEARLY

17%

# PARK TIME USE

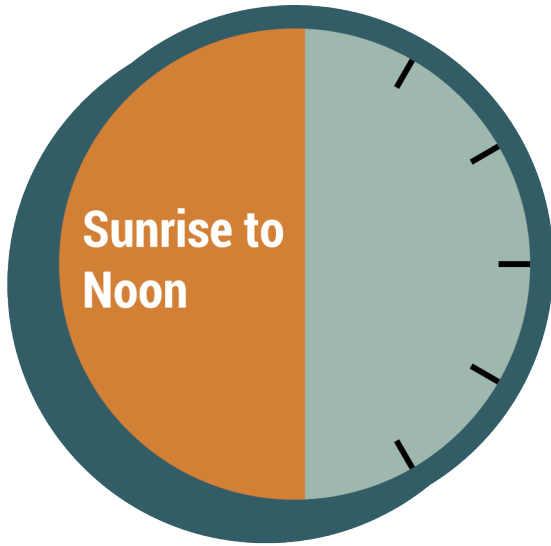

14%

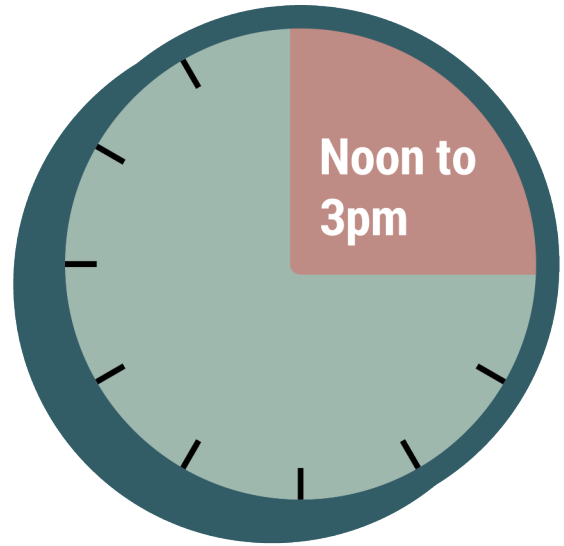

15%

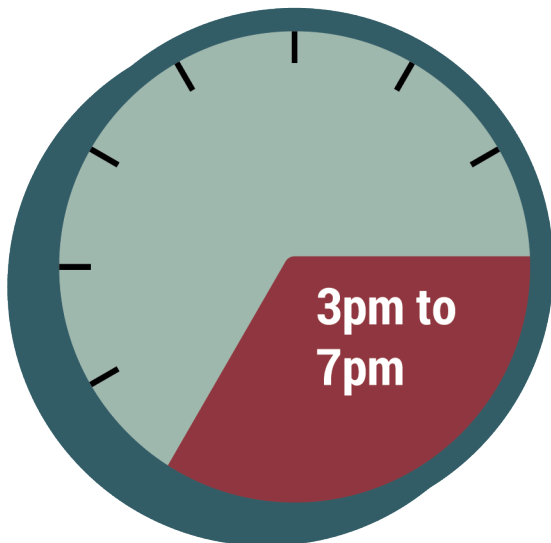

64%

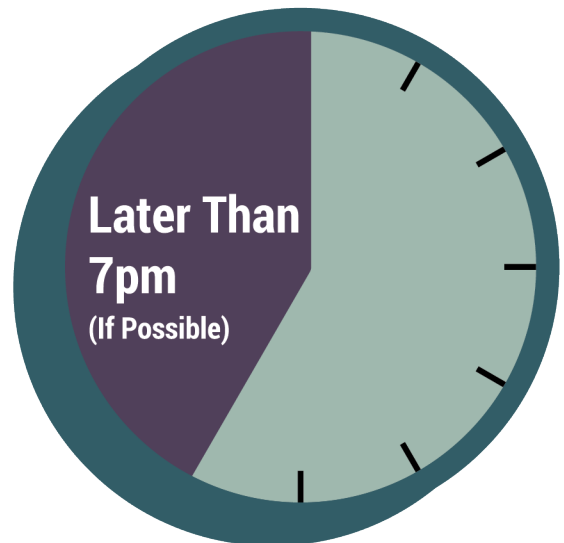

7%

# WHEELS OF CHOICE

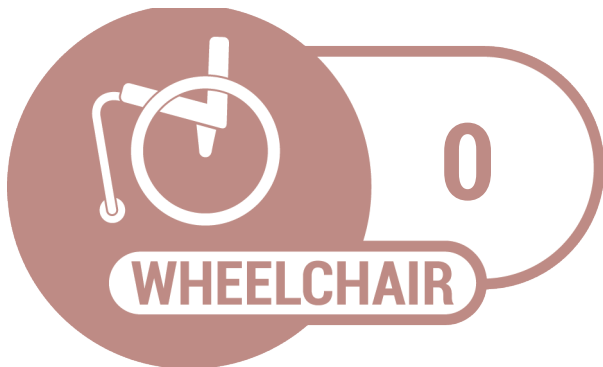
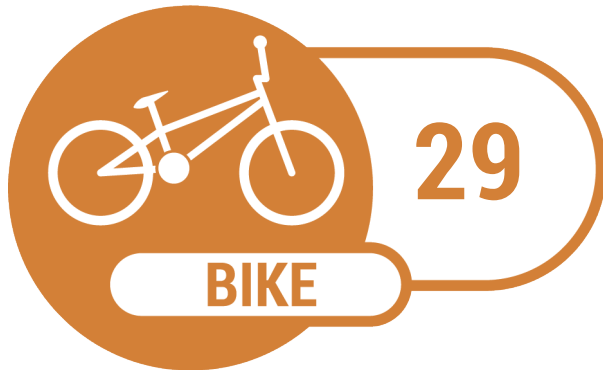

# SKILL LEVEL

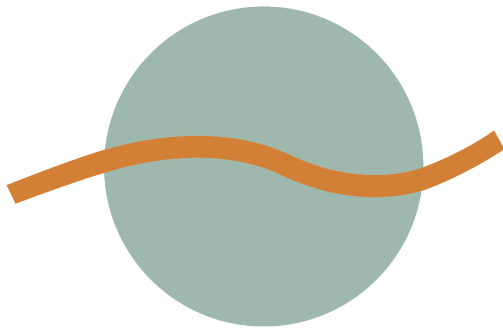

BEGINNER

35%

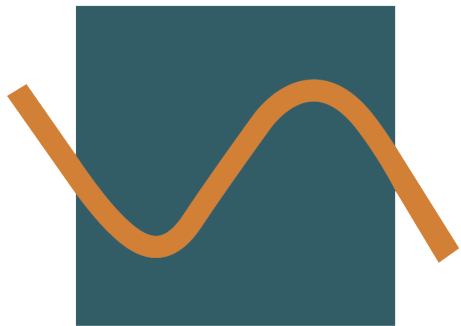

INTERMEDIATE

54%

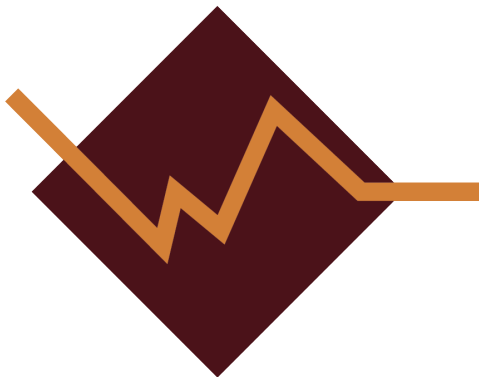

ADVANCED

11%

# STREET TO TRANSITION

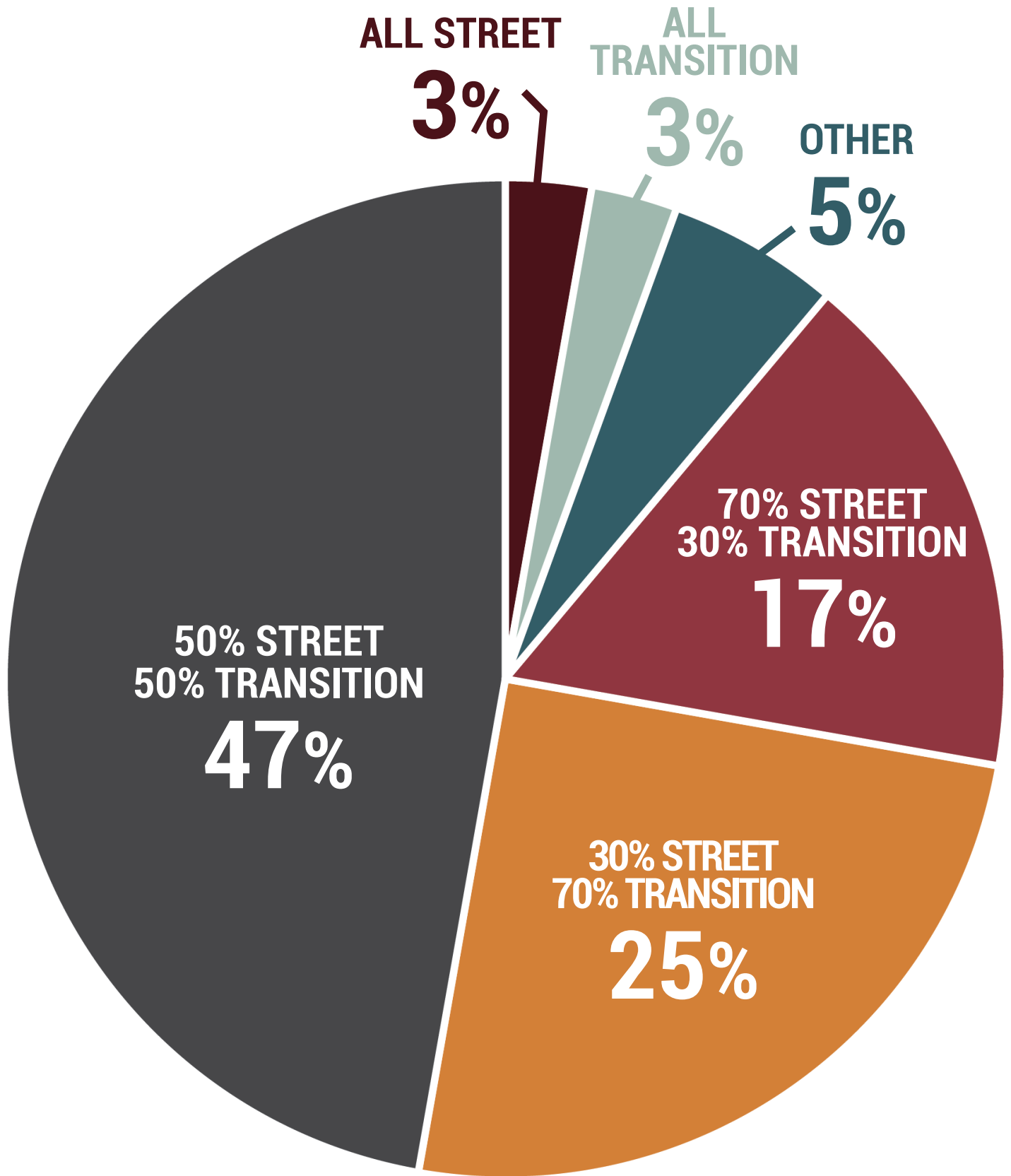

# RAIL PREFERENCE

ROUND

19.5%

SQUARE

19.5%

50/50

61%



# RADII (QUARTER PIPES/BOWLS/MINI RAMPS)

TIGHT RADII

7%

NO  
PREFERENCE

13%

MIX OF BOTH

47%

MELLOW  
RADII

33%

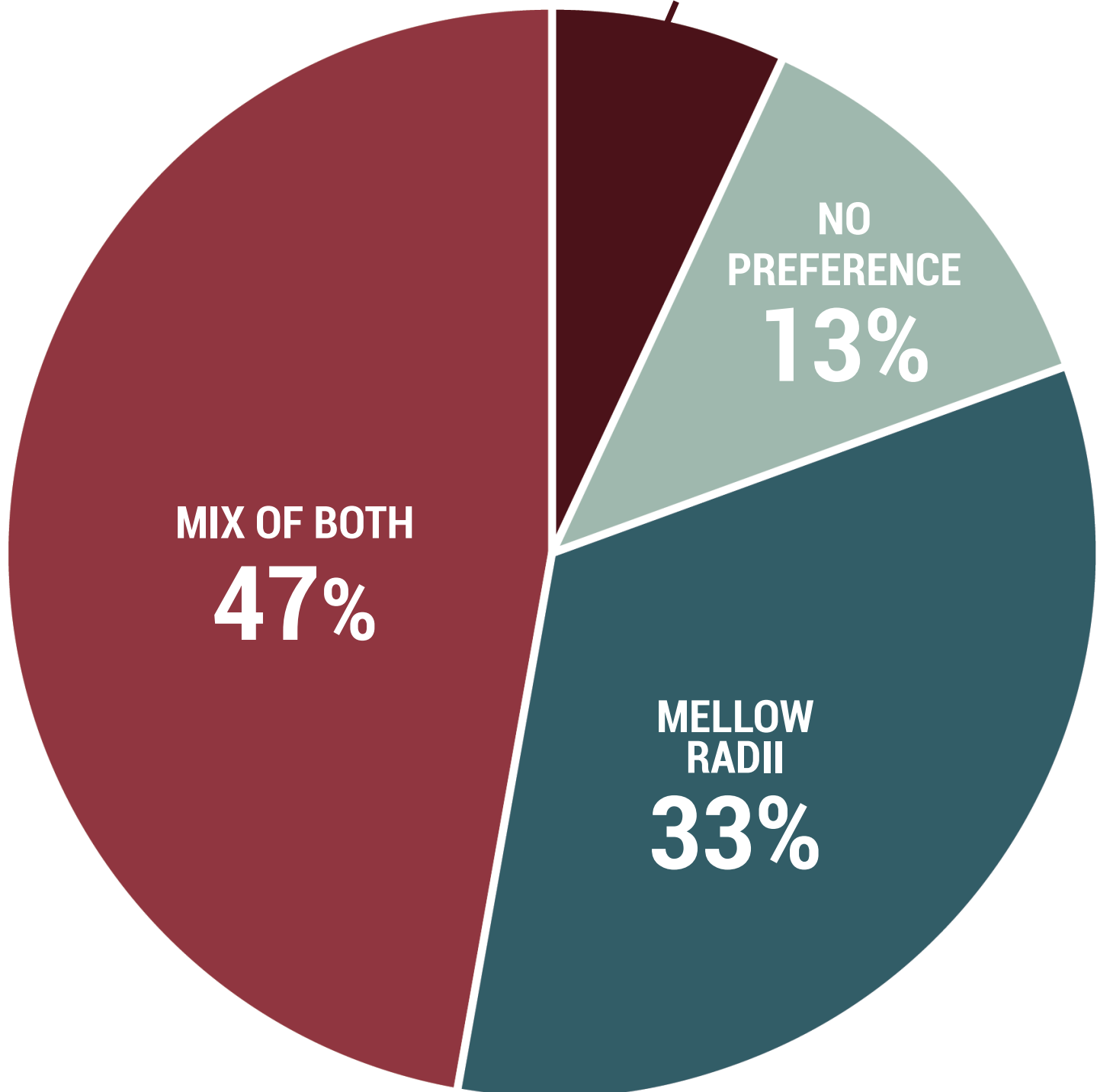

# HEIGHT (QUARTER PIPES/BOWLS/MINI RAMPS)

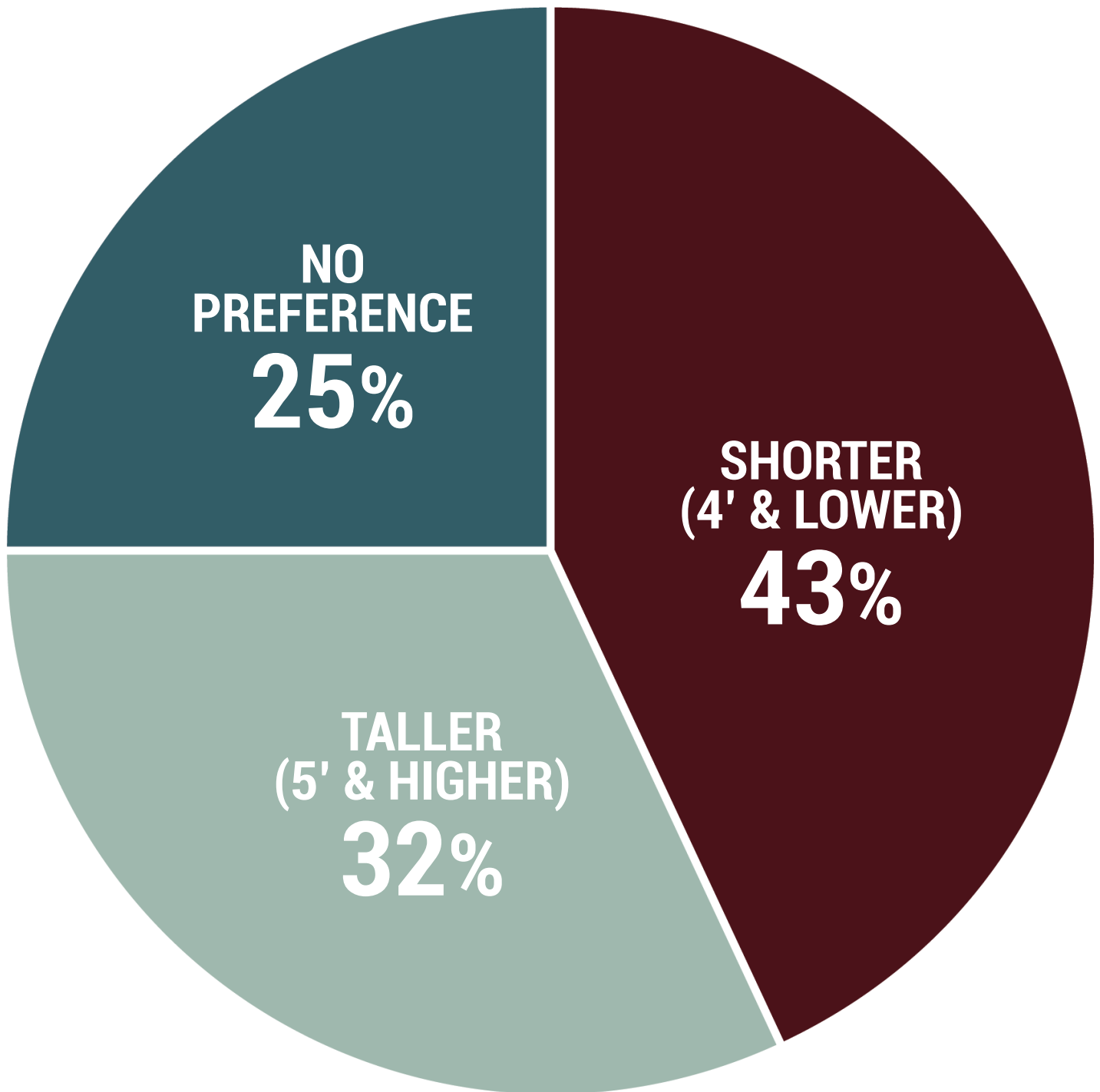



# COMMENTS

Having a nice mix of jumps, manual areas and flow, for all skill levels and with ability to progress.

Improved lighting would make summer nights awesome!

Some shade structure would be good.

# DESIGNS BASED ON SURVEY RESULTS



# COMMUNITY ENGAGEMENT MEETING CHOICE

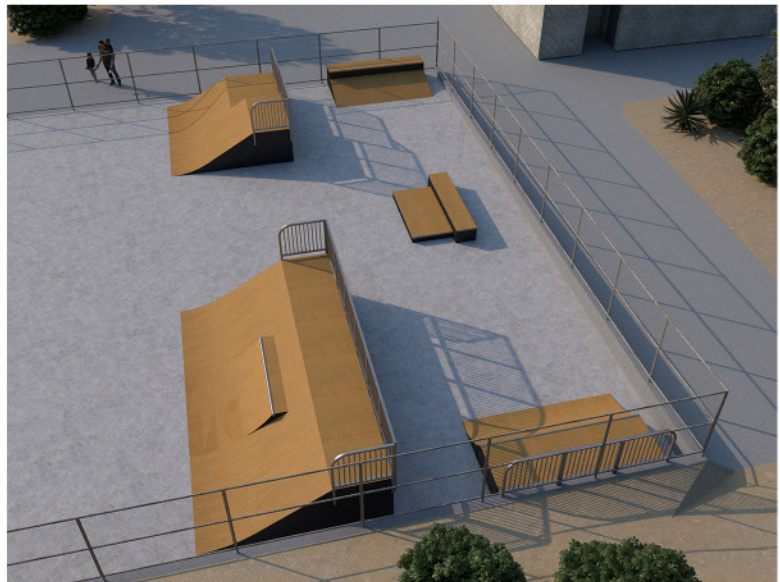
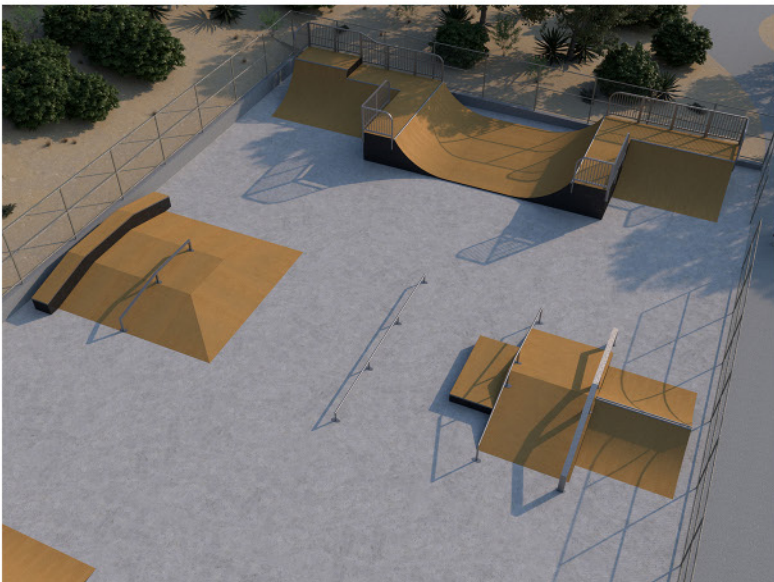

# FINAL DESIGN ADDITIONS

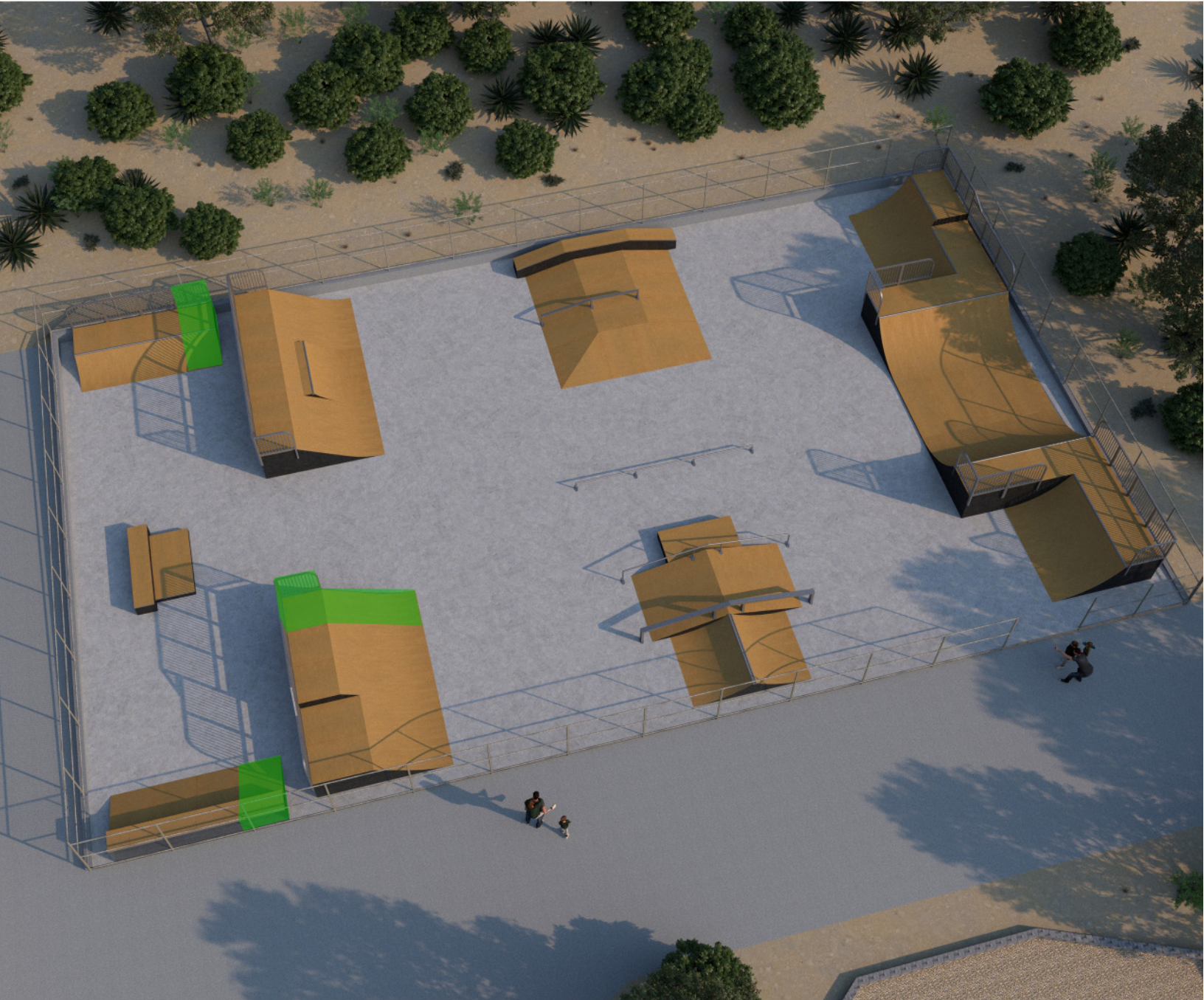

**Additions highlighted in green.**

# FINAL DESIGN

