

DEPARTMENT OF PUBLIC UTILITIES PIEDRA LOOP ELECTRIC REPLACEMENT PROJECT IFB-25- LOS ALAMOS COUNTY - NEW MEXICO

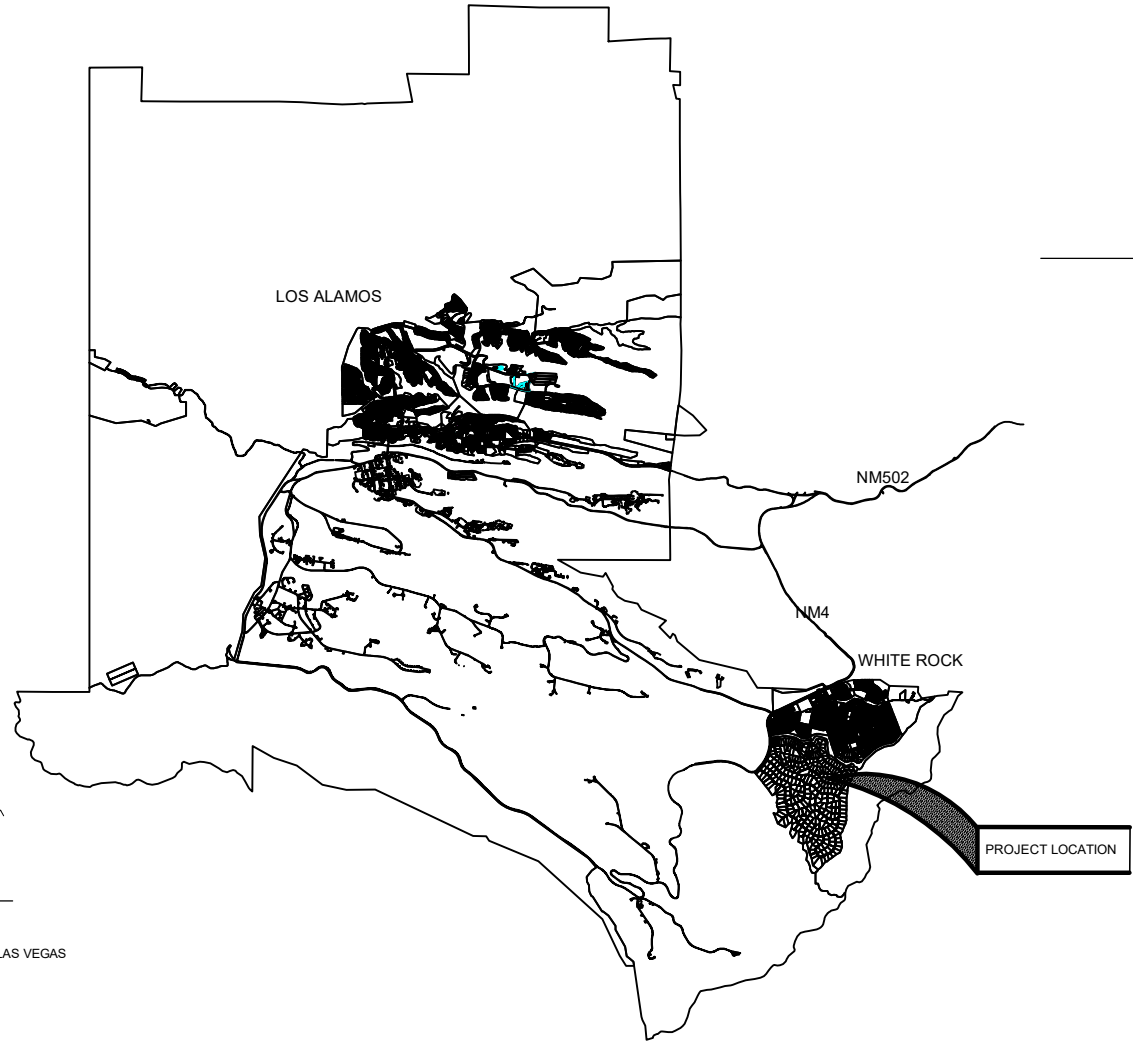
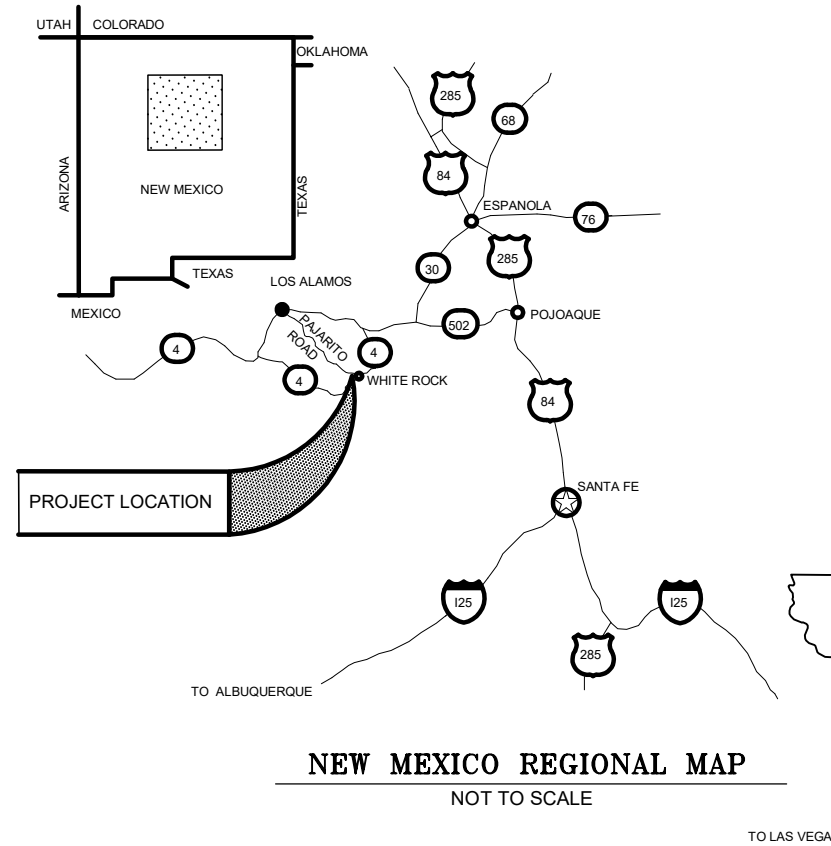

SHEET INDEX

- E1 COVER SHEET
- E2 STATION 00+00 TO 07+00 ELECTRIC
- E3 STATION 00+00 TO 07+00 FIBER
- E4 STATION 06+00 TO 15+00 ELECTRIC
- E5 STATION 06+00 TO 15+00 FIBER
- E6 STATION 20+00 TO 30+00 ELECTRIC
- E7 STATION 20+00 TO 30+00 FIBER
- E8 STATION 31+00 TO 41+00 ELECTRIC
- E9 STATION 31+00 TO 41+00 FIBER

- DETAIL SHEETS
- E10 CONDUIT INTO FLUSH MOUNT BOXES
- E11 CONDUIT INTO TRANSFORMERS
- E12 FLUSH MOUNT BOX DETAILS
- E13 TRENCH DETAIL

APPROVED BY: _____ DATE _____
DEPARTMENT OF PUBLIC UTILITIES MANAGER

DEPARTMENT OF PUBLIC UTILITIES ENGINEERING

NO.	REVISION DESCRIPTION
1	
2	
3	
4	
5	

DESIGNED BY: S. MAREZ
DRAWN BY: S. MAREZ
APPROVED BY: _____
DATE: _____
SCALE: _____

**PIEDRA LOOP
PRIMARY ELECTRIC PROJECT**



INCORPORATED COUNTY
OF LOS ALAMOS
DEPARTMENT OF PUBLIC
UTILITIES
1000 CENTRAL AVE., SUITE 130
LOS ALAMOS, NEW MEXICO 87544
(505) 662-8333 FAX: (505) 662-8005

SHEET
E1

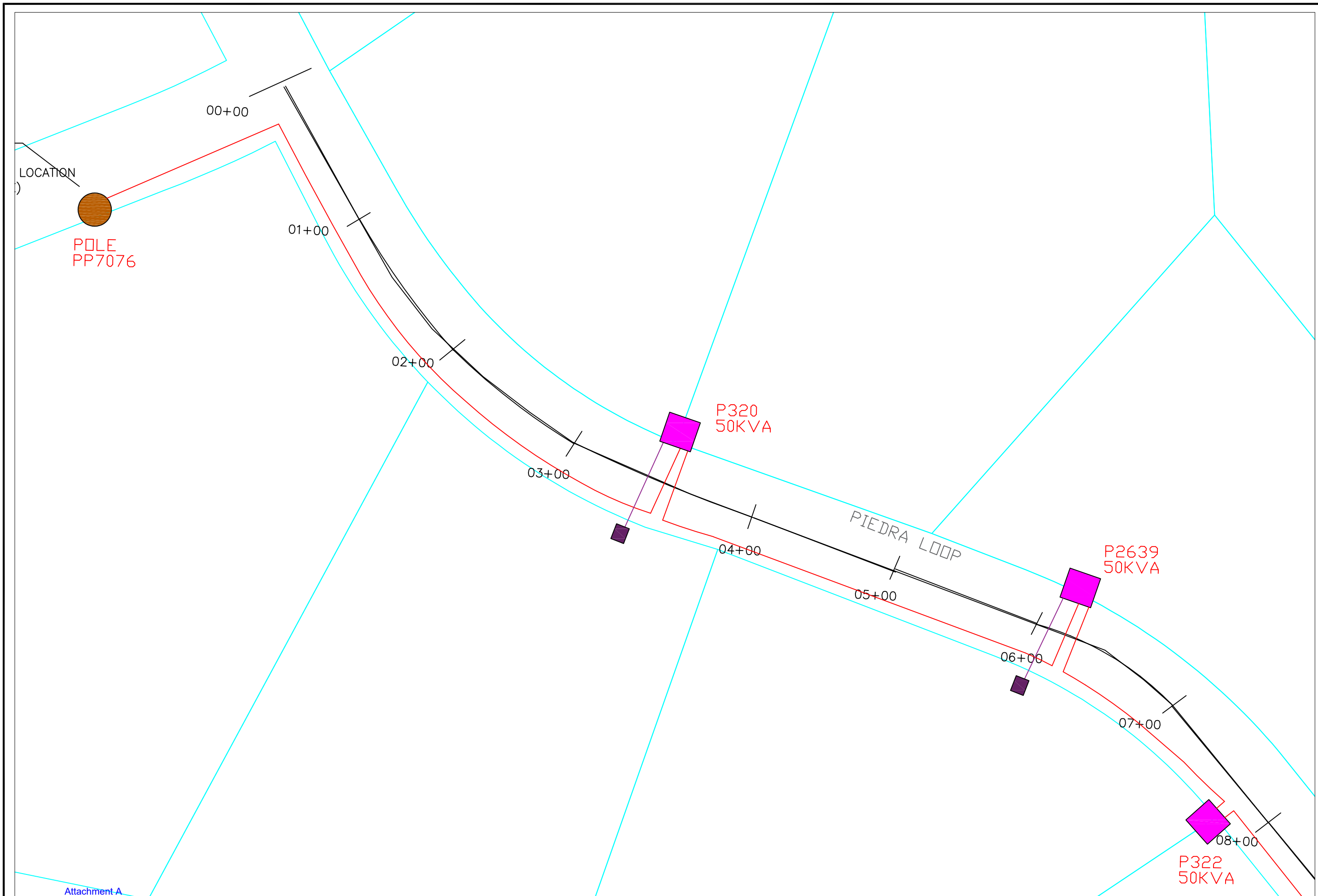

NO.	REVISION DESCRIPTION
1	
2	
3	
4	
5	

DESIGNED BY: S. MAREZ
 DRAWN BY: M. MONTOYA
 APPROVED BY: D. ASTLEY
 DATE: _____
 SCALE: _____

PIEDRA LOOP
PRIMARY ELECTRIC PROJECT

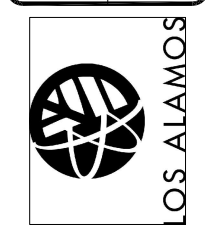

INCORPORATED COUNTY
 OF LOS ALAMOS
 DEPARTMENT OF PUBLIC
 UTILITIES
 1000 CENTRAL AVE., SUITE 130
 LOS ALAMOS, NEW MEXICO 87544
 (505) 662-8333 FAX: (505) 662-8005

SHEET
E2

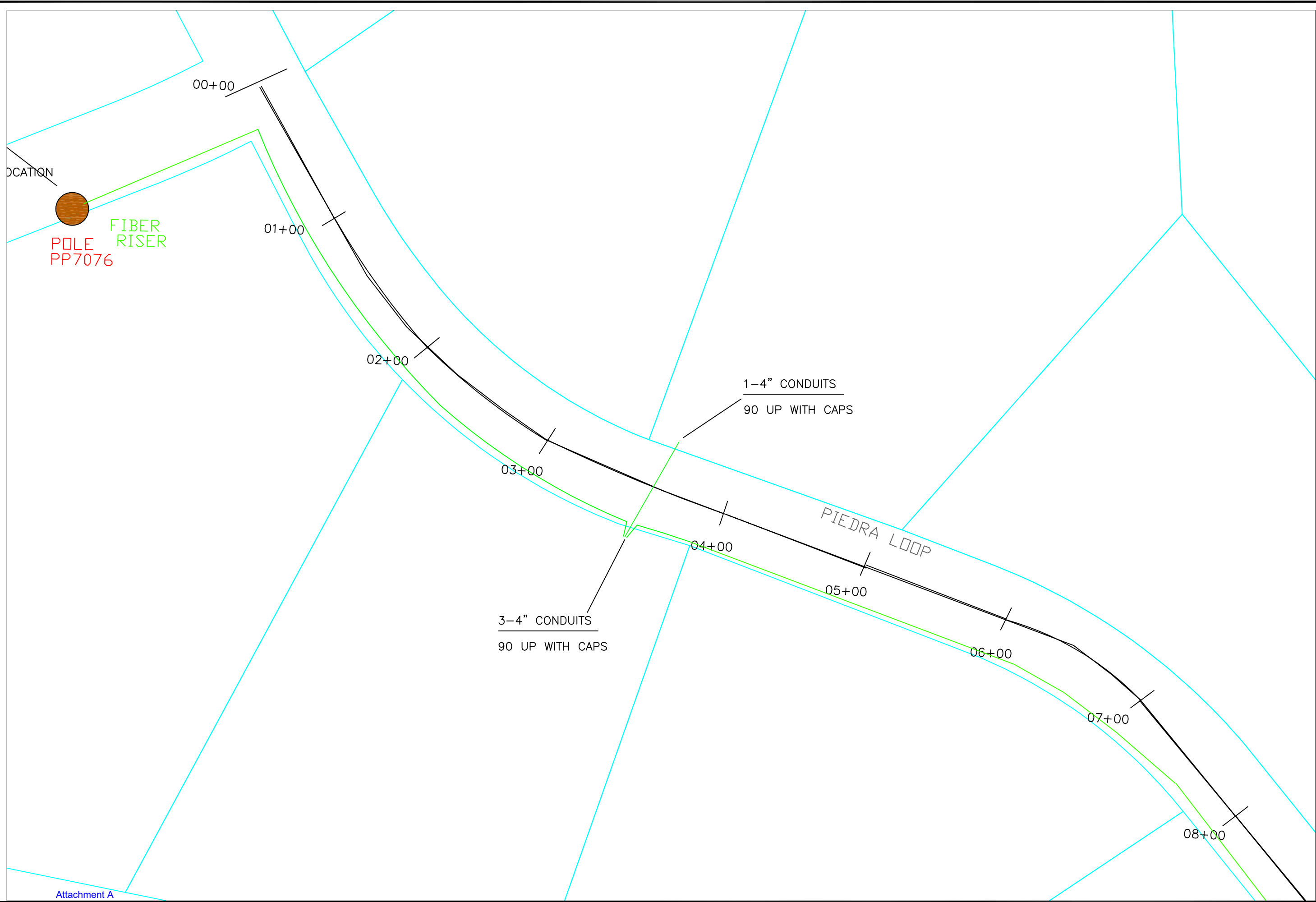

Attachment A

NO.	REVISION DESCRIPTION
1	
2	
3	
4	
5	

DESIGNED BY: S. MAREZ
 DRAWN BY: M. MONTONA
 APPROVED BY: D. ASTLEY
 DATE: _____
 SCALE: _____

PIEDRA LOOP FIBER

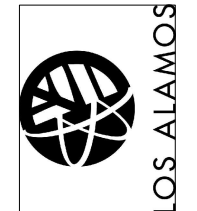

INCORPORATED COUNTY
 OF LOS ALAMOS
 DEPARTMENT OF PUBLIC
 UTILITIES
 1000 CENTRAL AVE., SUITE 130
 LOS ALAMOS, NEW MEXICO 87544
 (505) 662-8333 FAX: (505) 662-8005

SHEET
E3

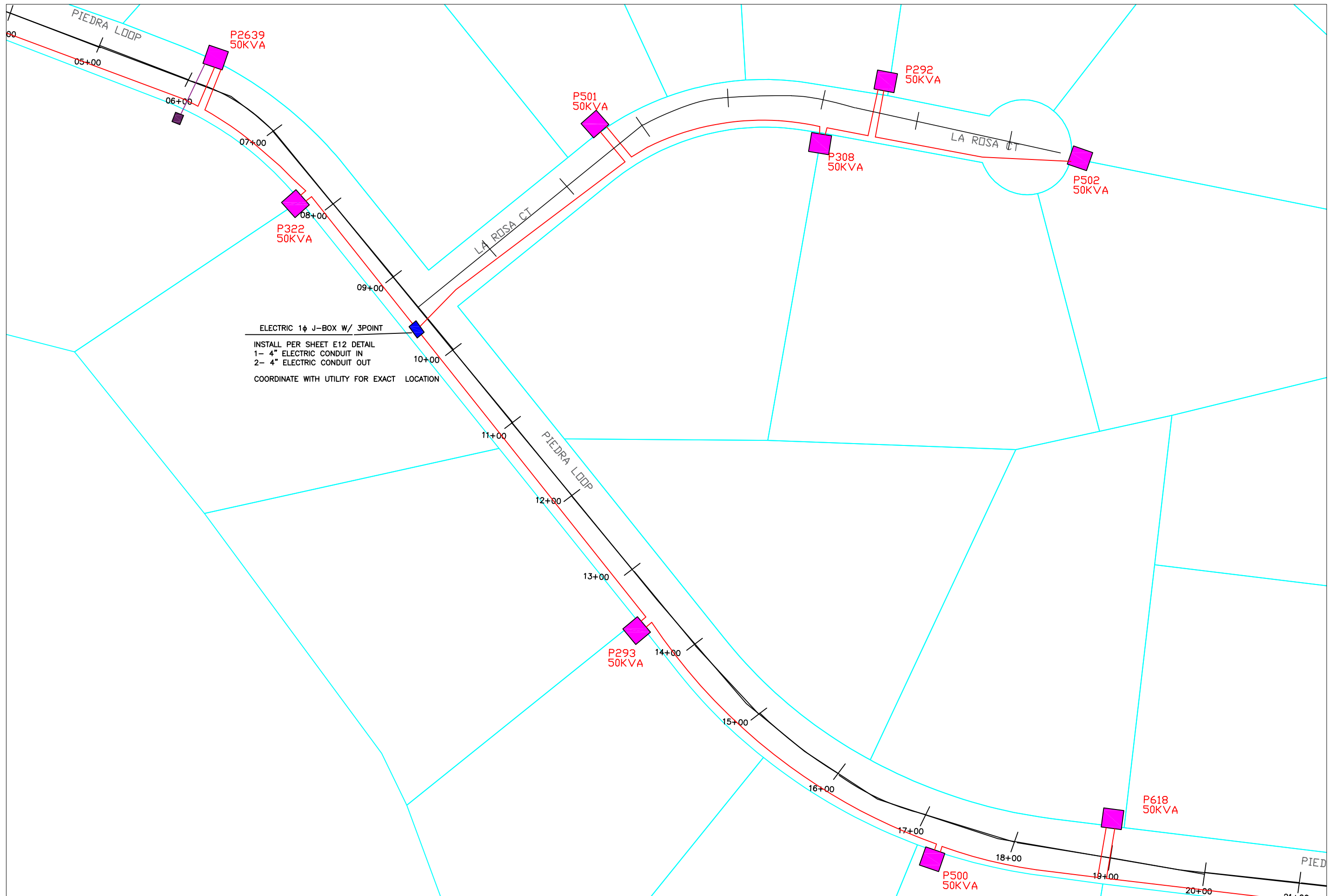

Attachment A

NO.	REVISION DESCRIPTION
1	
2	
3	
4	
5	

DESIGNED BY: S. MAREZ
 DRAWN BY: M. MONTOYA
 APPROVED BY: D. ASTLEY
 DATE: _____
 SCALE: _____

**PIEDRA LOOP
 PRIMARY ELECTRIC PROJECT**



INCORPORATED COUNTY
 OF LOS ALAMOS
 DEPARTMENT OF PUBLIC
 UTILITIES
 1000 CENTRAL AVE., SUITE 130
 LOS ALAMOS, NEW MEXICO 87544
 (505) 662-8333 FAX: (505) 662-8005

SHEET
E4

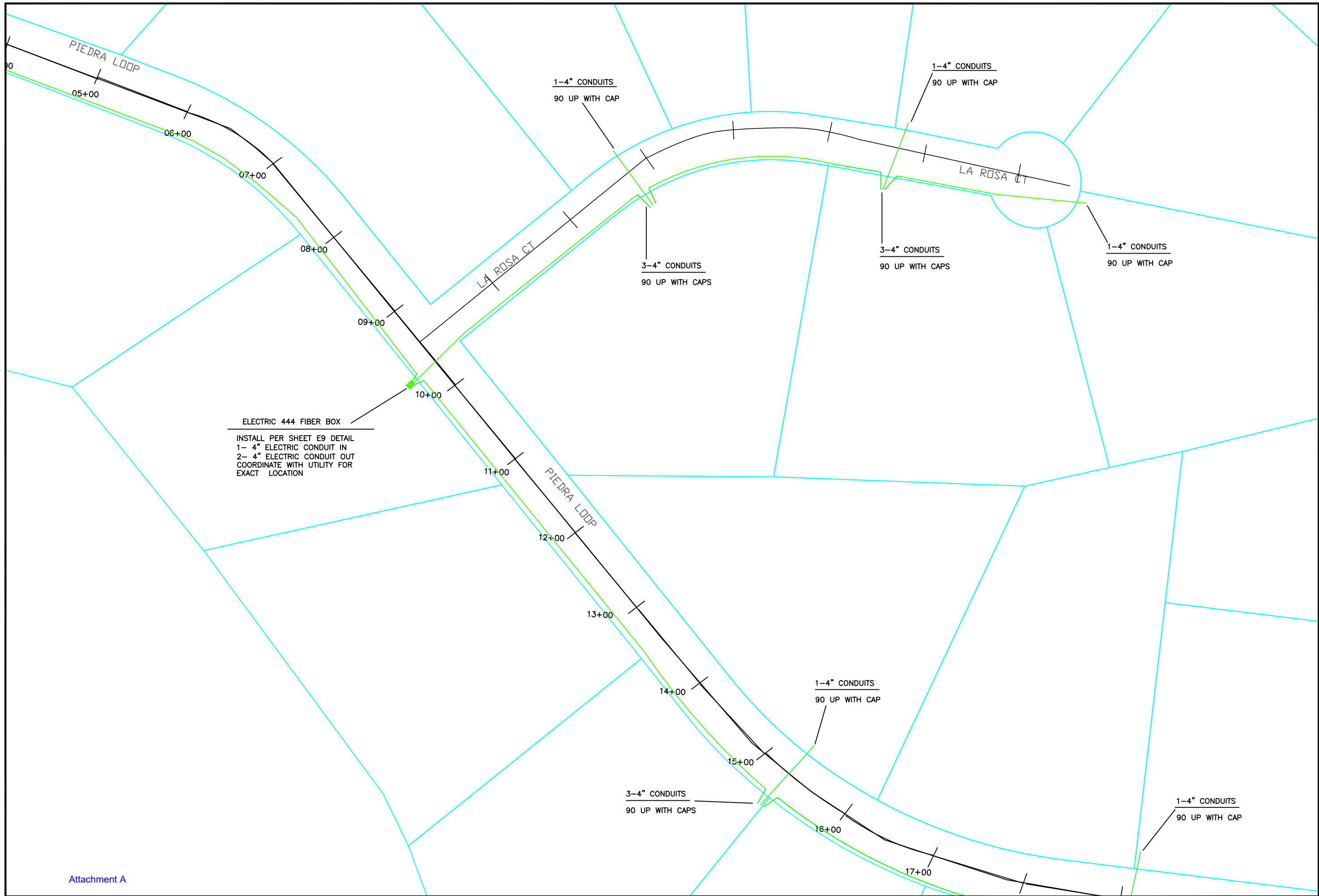

ELECTRIC 444 FIBER BOX
 INSTALL PER SHEET E9 DETAIL
 1- 4" ELECTRIC CONDUIT IN
 2- 4" ELECTRIC CONDUIT OUT
 COORDINATE WITH UTILITY FOR
 EXACT LOCATION

NO.	REVISION DESCRIPTION
1	
2	
3	
4	
5	

DESIGNED BY: S. MAREZ
 DRAWN BY: M. MONTOYA
 APPROVED BY: D. ASTLEY
 DATE: _____
 SCALE: _____

PIEDRA LOOP FIBER



INCORPORATED COUNTY
 OF LOS ALAMOS
 DEPARTMENT OF PUBLIC
 UTILITIES
 1000 CENTRAL AVE., SUITE 130
 LOS ALAMOS, NEW MEXICO 87544
 (505) 662-8333 FAX: (505) 662-8005

SHEET
E5

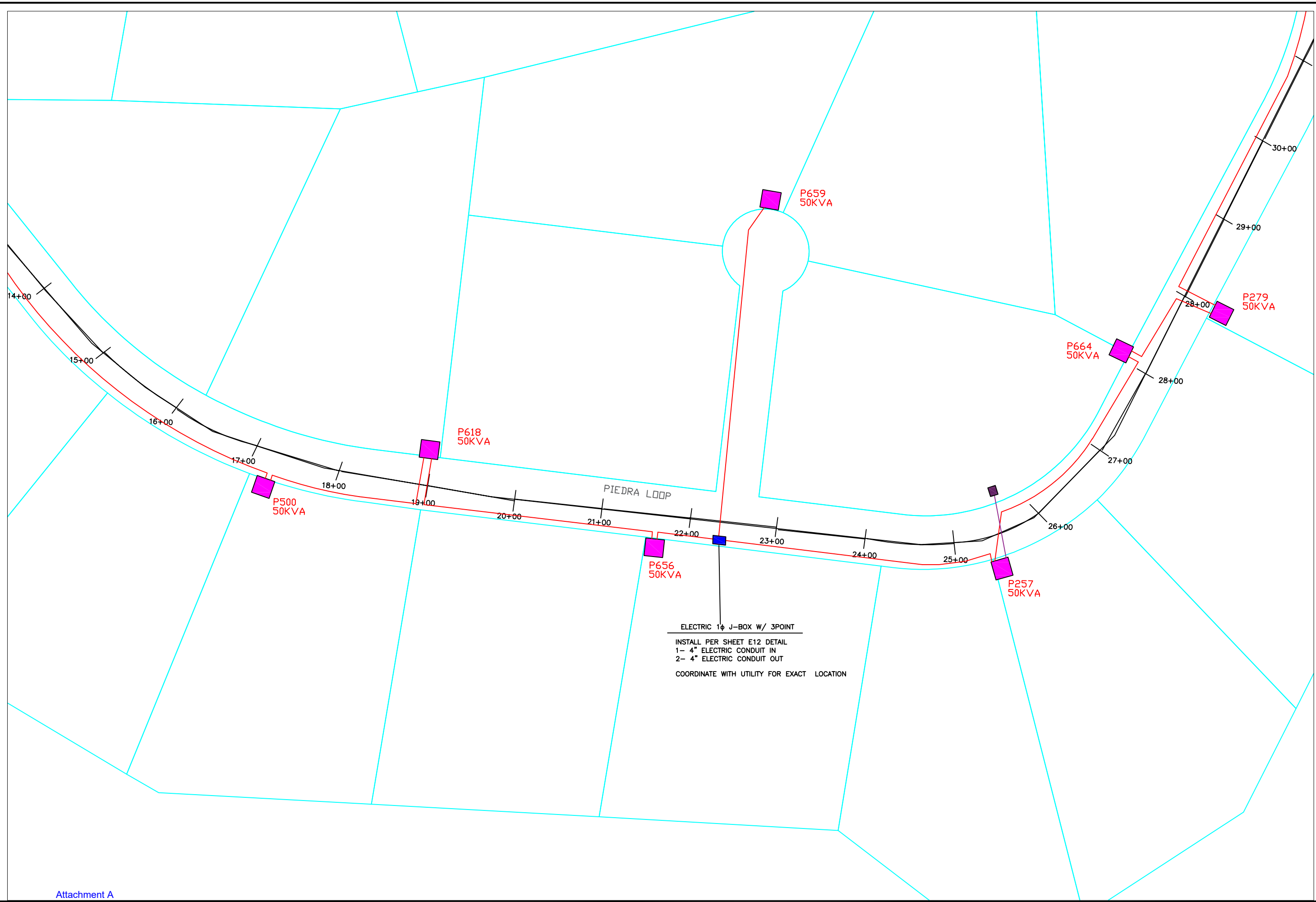

ELECTRIC 1 ϕ J-BOX W/ 3POINT
 INSTALL PER SHEET E12 DETAIL
 1- 4" ELECTRIC CONDUIT IN
 2- 4" ELECTRIC CONDUIT OUT
 COORDINATE WITH UTILITY FOR EXACT LOCATION

NO.	REVISION DESCRIPTION
1	
2	
3	
4	
5	

DESIGNED BY: S. MAREZ
 DRAWN BY: M. MONTOYA
 APPROVED BY: D. ASTLEY
 DATE: _____
 SCALE: _____

**PIEDRA LOOP
 PRIMARY ELECTRIC PROJECT**



INCORPORATED COUNTY
 OF LOS ALAMOS
 DEPARTMENT OF PUBLIC
 UTILITIES
 1000 CENTRAL AVE., SUITE 130
 LOS ALAMOS, NEW MEXICO 87544
 (505) 662-8333 FAX: (505) 662-8005

SHEET
E6

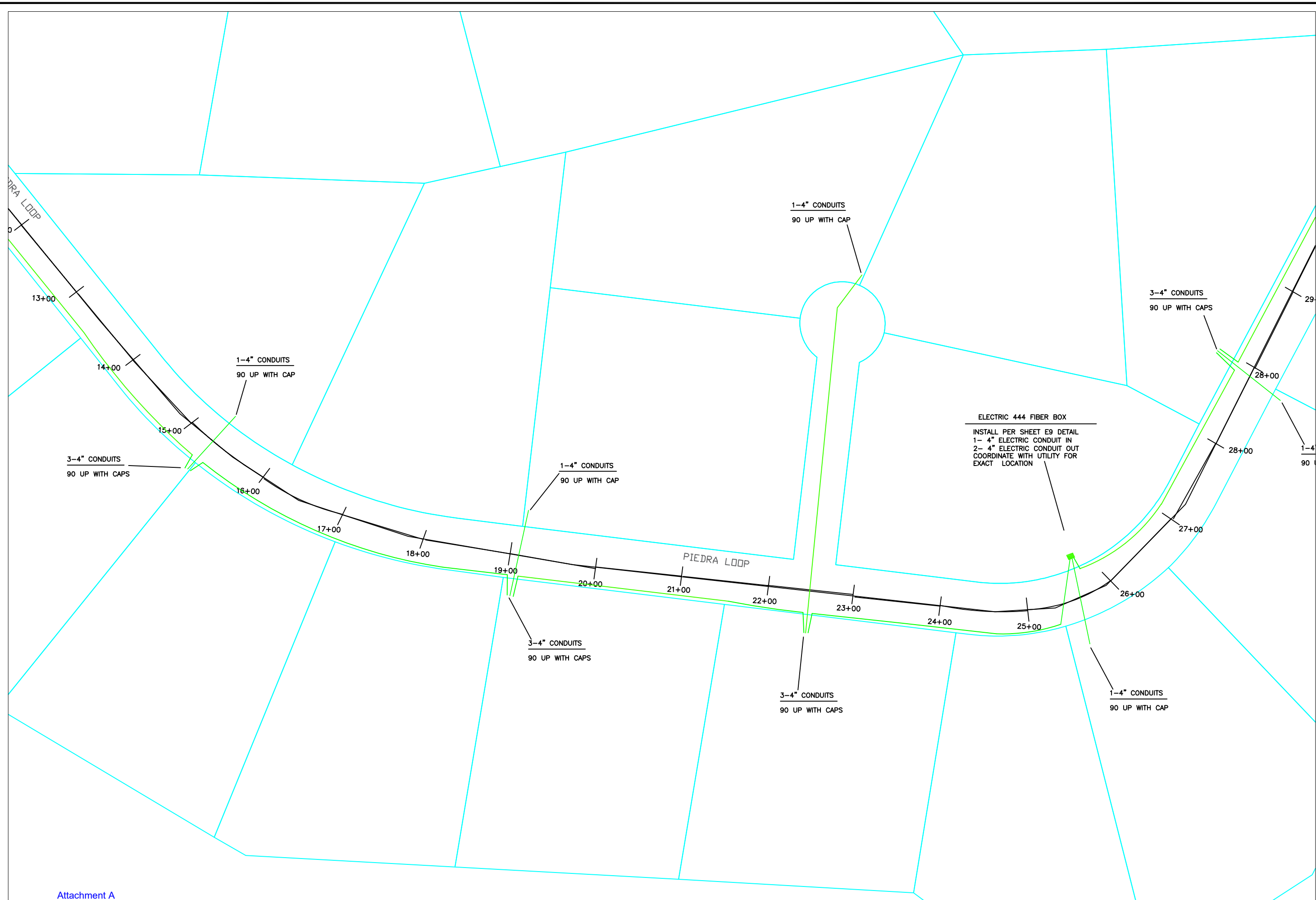

Attachment A

NO.	REVISION DESCRIPTION
1	
2	
3	
4	
5	

DESIGNED BY: S. MAREZ
 DRAWN BY: S. MAREZ
 APPROVED BY: _____
 DATE: _____
 SCALE: _____

PIEDRA LOOP FIBER



INCORPORATED COUNTY
 OF LOS ALAMOS
 DEPARTMENT OF PUBLIC
 UTILITIES
 1000 CENTRAL AVE., SUITE 130
 LOS ALAMOS, NEW MEXICO 87544
 (505) 662-8333 FAX: (505) 662-8005

SHEET
E7

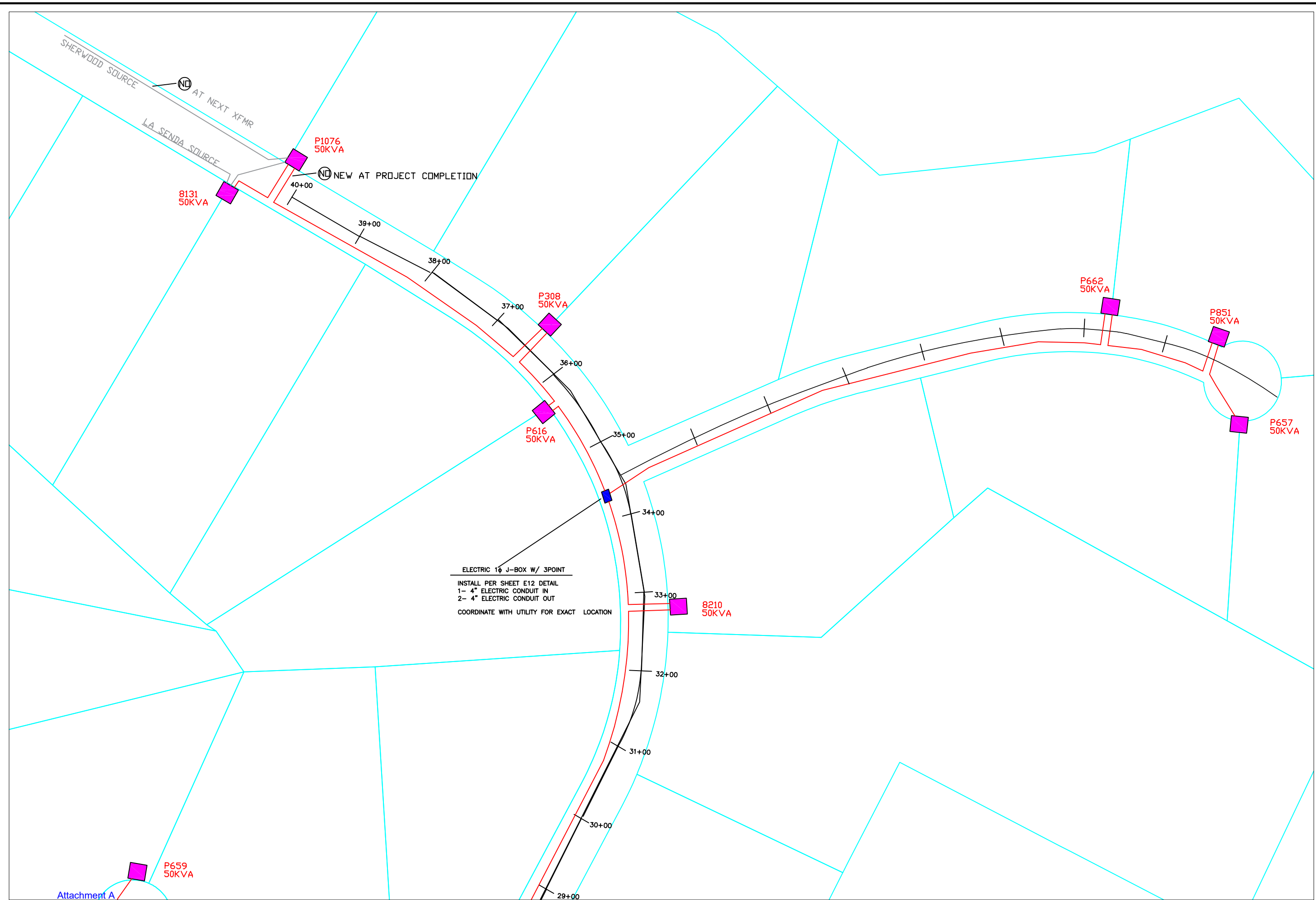

NO.	REVISION DESCRIPTION
1	
2	
3	
4	
5	

DESIGNED BY: S. MAREZ
 DRAWN BY: M. MONTYA
 APPROVED BY: D. ASTILE
 DATE: _____
 SCALE: _____

PIEDRA LOOP
PRIMARY ELECTRIC PROJECT

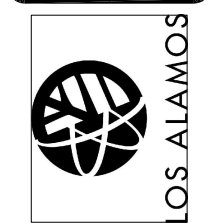

INCORPORATED COUNTY
 OF LOS ALAMOS
 DEPARTMENT OF PUBLIC
 UTILITIES
 1000 CENTRAL AVE., SUITE 130
 LOS ALAMOS, NEW MEXICO 87544
 (505) 662-8333 FAX: (505) 662-8005

Attachment A

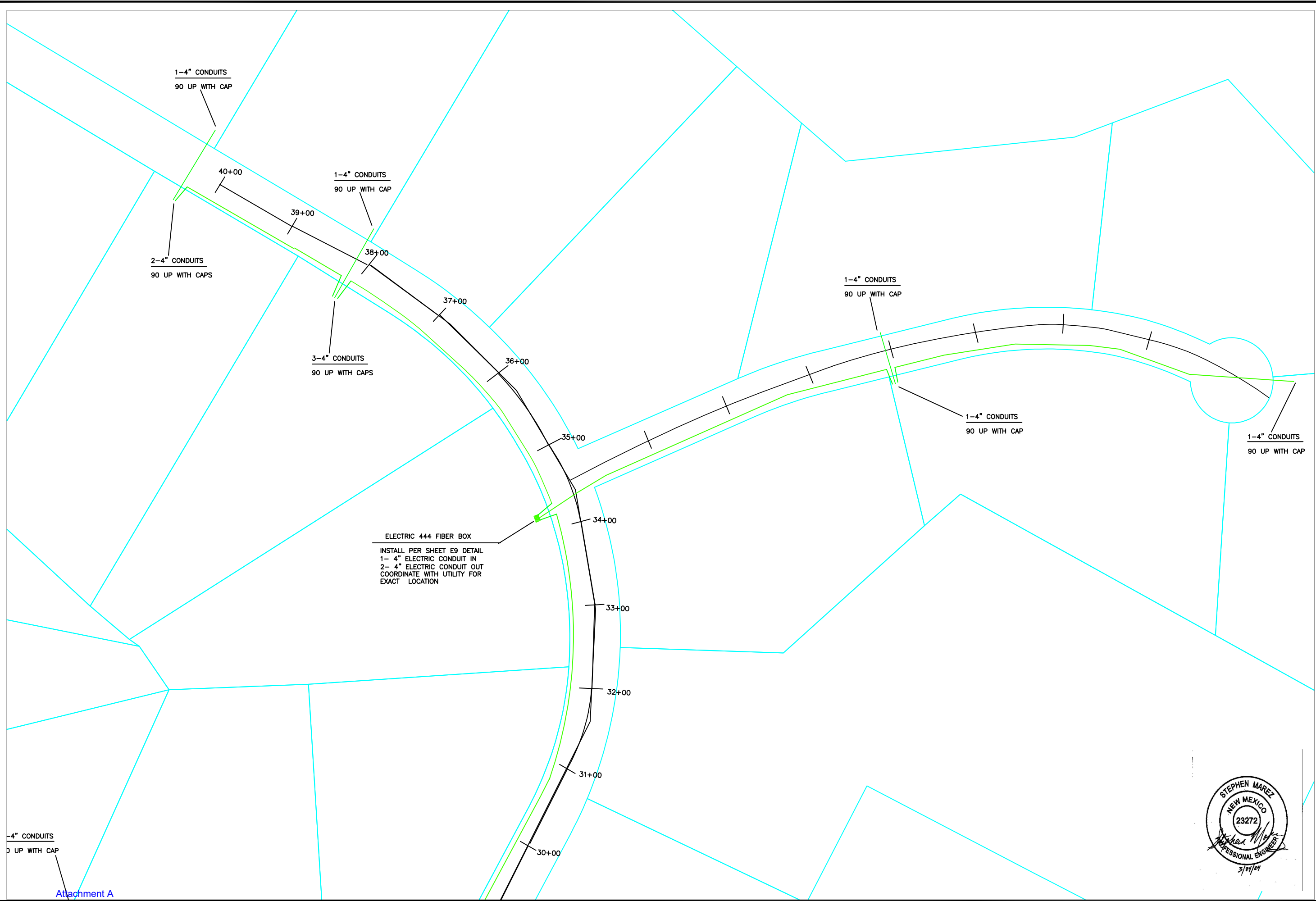

1-4" CONDUITS
90 UP WITH CAP

2-4" CONDUITS
90 UP WITH CAPS

1-4" CONDUITS
90 UP WITH CAP

3-4" CONDUITS
90 UP WITH CAPS

1-4" CONDUITS
90 UP WITH CAP

1-4" CONDUITS
90 UP WITH CAP

1-4" CONDUITS
90 UP WITH CAP

ELECTRIC 444 FIBER BOX
INSTALL PER SHEET E9 DETAIL
1- 4" ELECTRIC CONDUIT IN
2- 4" ELECTRIC CONDUIT OUT
COORDINATE WITH UTILITY FOR
EXACT LOCATION

1-4" CONDUITS
90 UP WITH CAP

Attachment A



NO.	REVISION DESCRIPTION
1	
2	
3	
4	
5	

DESIGNED BY: S. MAREZ
DRAWN BY: S. MAREZ
APPROVED BY: _____
DATE: _____
SCALE: _____

PIEDRA LOOP FIBER



INCORPORATED COUNTY
OF LOS ALAMOS
DEPARTMENT OF PUBLIC
UTILITIES
1000 CENTRAL AVE., SUITE 130
LOS ALAMOS, NEW MEXICO 87544
(505) 662-8333 FAX: (505) 662-8005

SHEET
E9

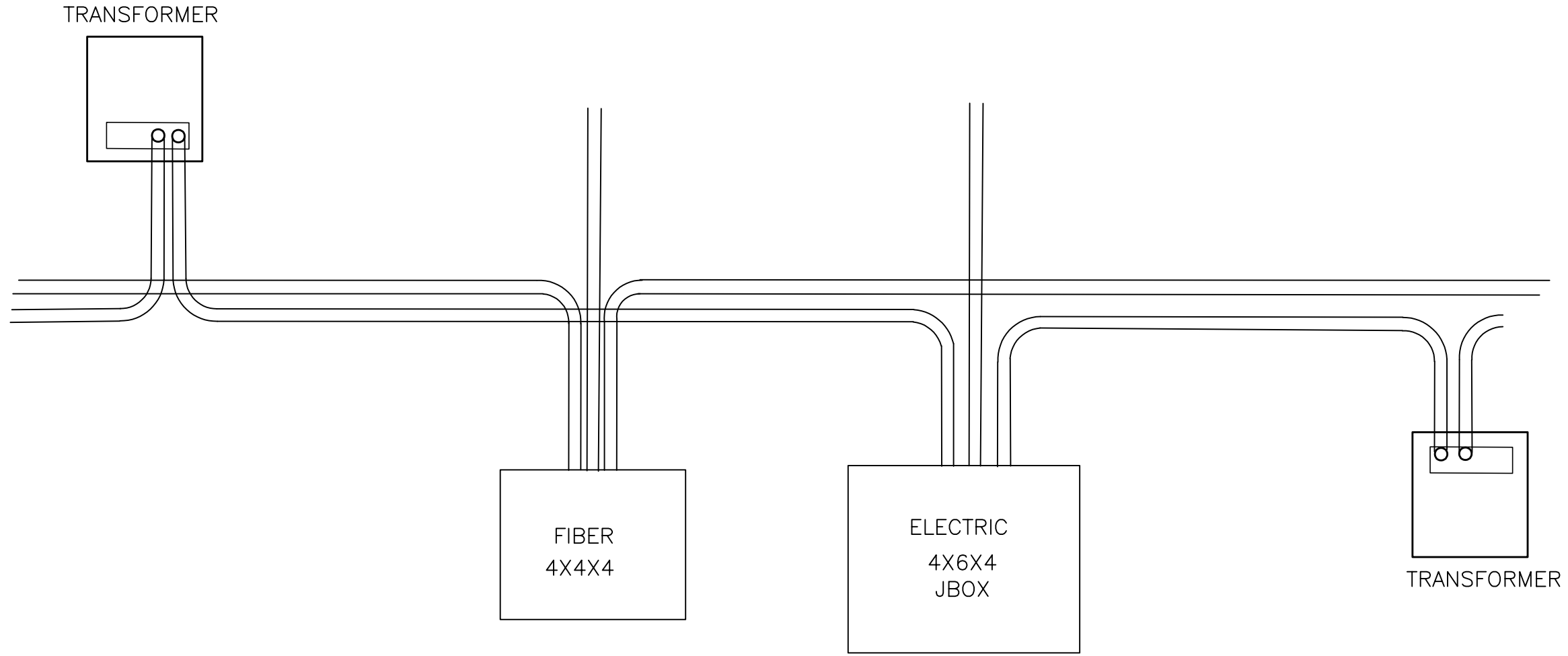

NO.	REVISION DESCRIPTION
1	
2	
3	
4	
5	

DESIGNED BY: S. MAREZ
 DRAWN BY: S. MAREZ
 APPROVED BY: _____
 DATE: _____
 SCALE: _____

**PIEDRA LOOP
 PRIMARY ELECTRIC PROJECT**

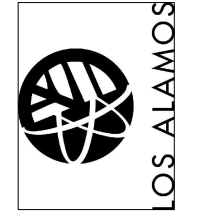

INCORPORATED COUNTY
 OF LOS ALAMOS
 DEPARTMENT OF PUBLIC
 UTILITIES
 1000 CENTRAL AVE., SUITE 130
 LOS ALAMOS, NEW MEXICO 87544
 (505) 662-8333 FAX: (505) 662-8005



SHEET
E10

CONDUIT STUBS INTO TRANSFORMERS AND PULL BOXIES

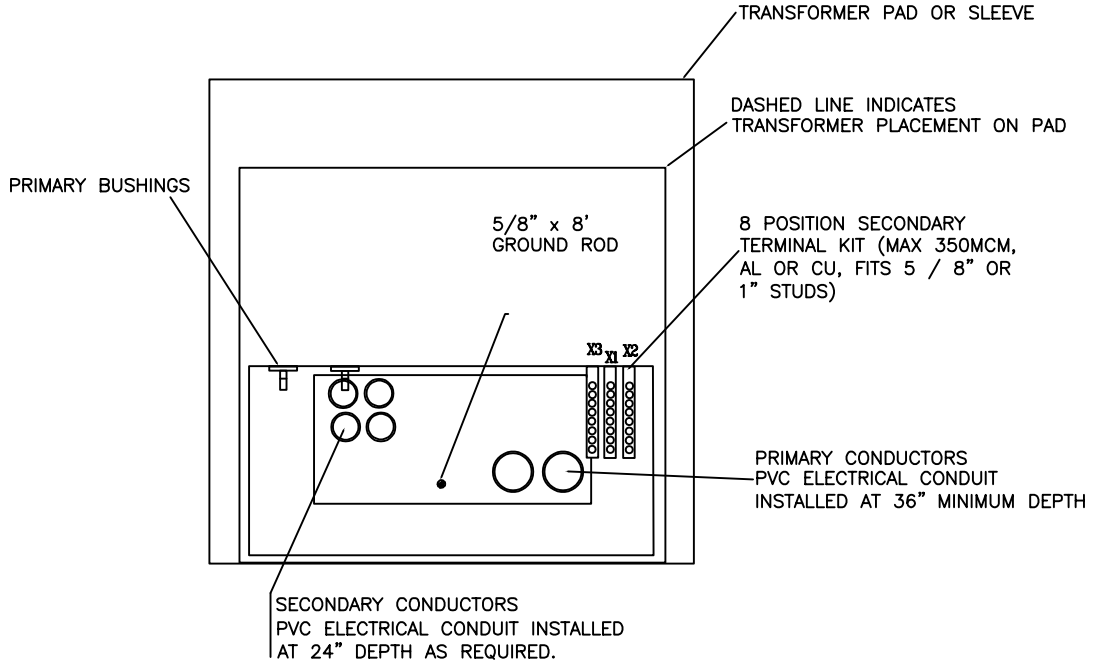

CONDUIT SIZES AND MATERIALS DETERMINED BY LACDPU ENGINEERING

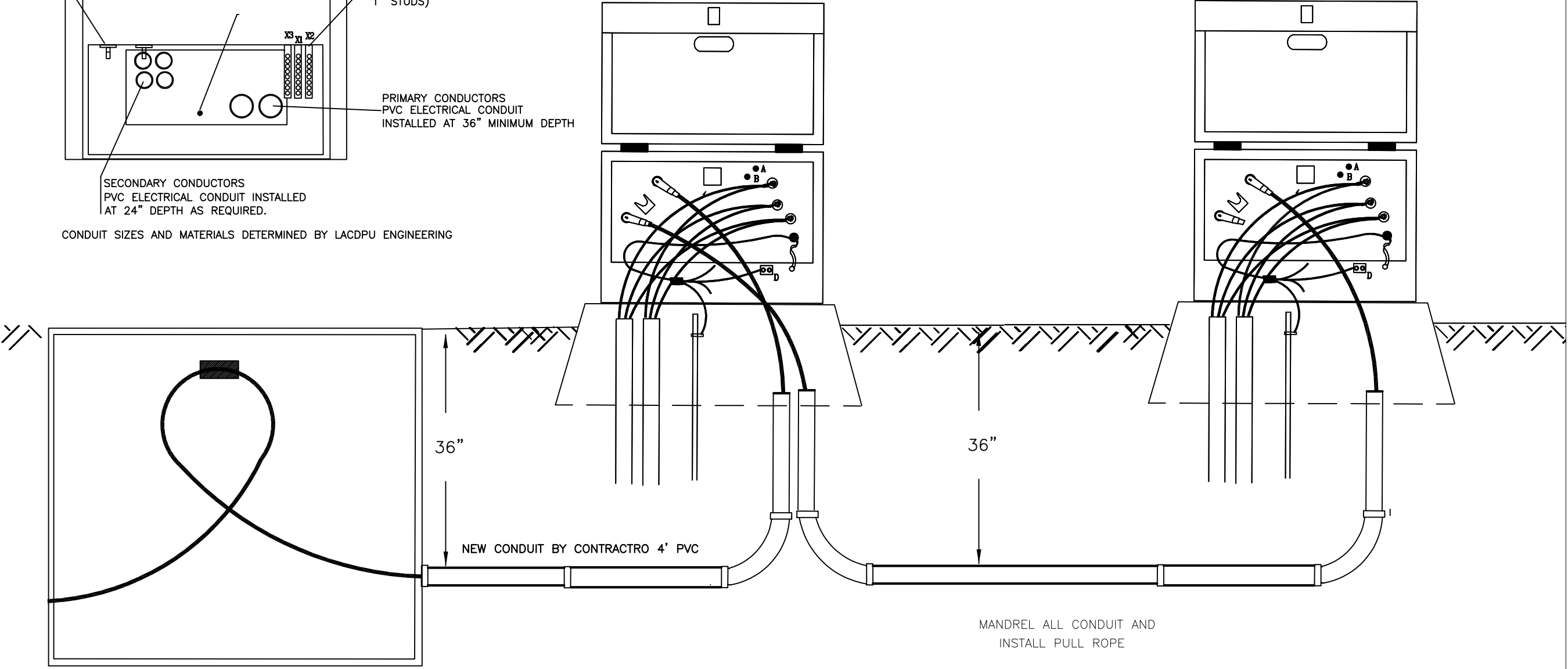

NO.	REVISION DESCRIPTION
1	
2	
3	
4	
5	

DESIGNED BY: S. MAREZ
 DRAWN BY: S. MAREZ
 APPROVED BY: _____
 DATE: _____
 SCALE: _____

**PIEDRA LOOP
 PRIMARY ELECTRIC PROJECT**



INCORPORATED COUNTY
 OF LOS ALAMOS
 DEPARTMENT OF PUBLIC
 UTILITIES
 1000 CENTRAL AVE., SUITE 130
 LOS ALAMOS, NEW MEXICO 87544
 (505) 662-8333 FAX: (505) 662-8005

SHEET
E11

DEPARTMENT OF
PUBLIC UTILITIES
LOS ALAMOS COUNTY
LOS ALAMOS, NEW MEXICO

UTILITY CONSTRUCTION STANDARDS - ELECTRIC
TRENCH DETAIL

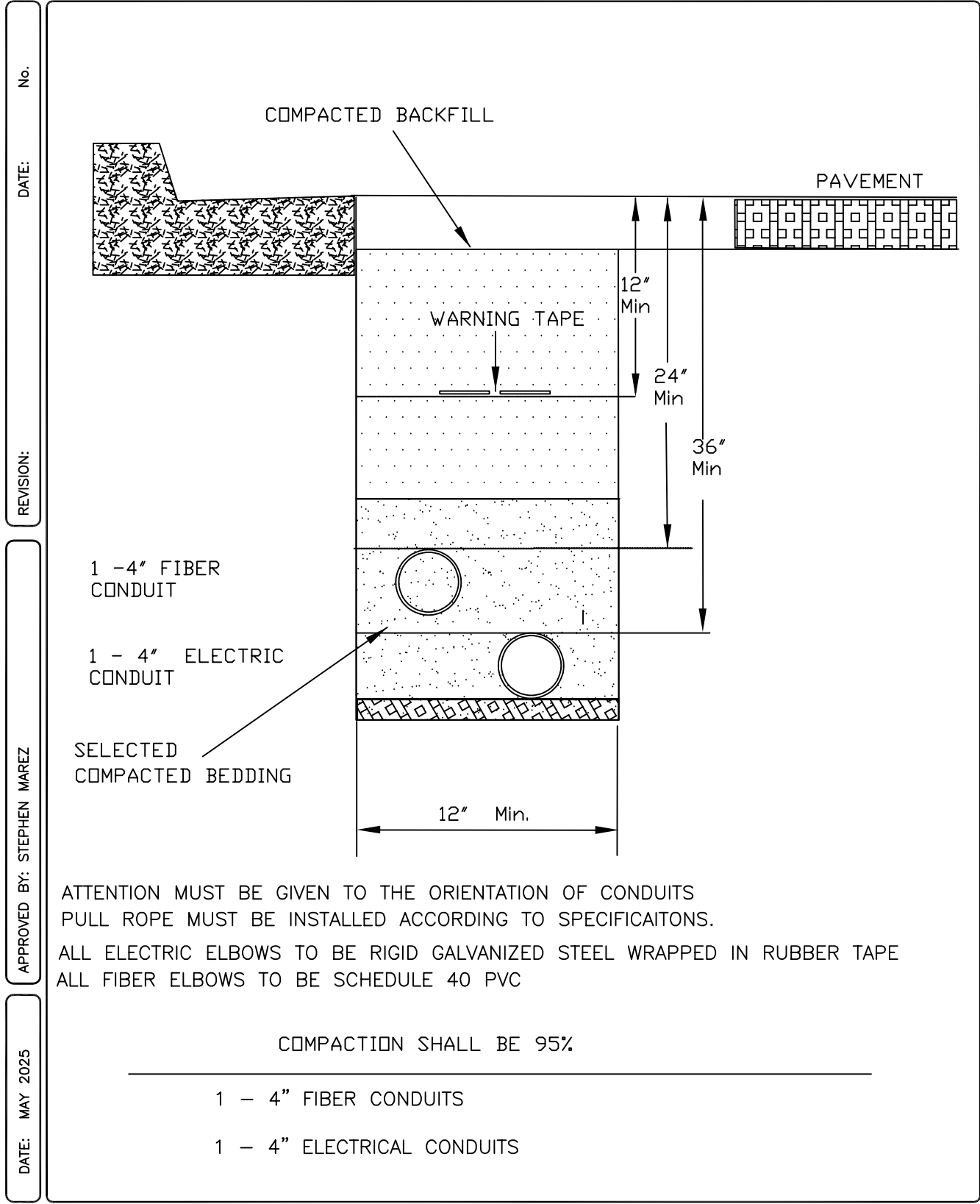

ATTENTION MUST BE GIVEN TO THE ORIENTATION OF CONDUITS
PULL ROPE MUST BE INSTALLED ACCORDING TO SPECIFICATION.
ALL ELECTRIC ELBOWS TO BE RIGID GALVANIZED STEEL WRAPPED IN RUBBER TAPE
ALL FIBER ELBOWS TO BE SCHEDULE 40 PVC

COMPACTION SHALL BE 95%

- 1 - 4" FIBER CONDUITS
- 1 - 4" ELECTRICAL CONDUITS

No. _____
DATE: _____
REVISION: _____
APPROVED BY: STEPHEN MAREZ
DATE: MAY 2025



NO.	REVISION DESCRIPTION
1	
2	
3	
4	
5	

DESIGNED BY: S. MAREZ
DRAWN BY: S. MAREZ
APPROVED BY: _____
DATE: _____
SCALE: _____

PIEDRA LOOP
PRIMARY ELECTRIC PROJECT



INCORPORATED COUNTY
OF LOS ALAMOS
DEPARTMENT OF PUBLIC
UTILITIES
1000 CENTRAL AVE., SUITE 130
LOS ALAMOS, NEW MEXICO 87544
(505) 662-8333 FAX: (505) 662-8005